



Advanced Acoustic Technology Corporation

Product Catalogue

Buzzers



Micro-Speakers



Receivers



Microphones



AATC

Table of Content

About Us	2
Selection Guide.....	3
Magnetic Buzzers (Transducers).....	5
Magnetic Buzzers (Indicators)	11
Piezo Buzzers (Transducers)	13
Piezo Buzzers (Indicators/ Sirens).....	15
Piezo Plates	17
Micro-Speakers (Circular)	18
Micro-Speakers (Oval/ Rectangular)	23
Micro-Speakers (With Box)	27
Receivers	28
Microphones (Omni-Directional; Wire/ Dip).....	30
Microphones (Omni-Directional; SMD)	33
Microphones (Uni-Directional; Wire/ Dip).....	34
Contact Us.....	35

About Us

Who are we?

Advanced Acoustic Technology Corporation (AATC) is an industry-leading acoustic company with locations in Taiwan and China. We have above 20 years of experience in designing, manufacturing and marketing acoustic products, which include buzzers, micro-speakers, receivers and microphones.

Our products are widely used in consumer electronics, smart appliances, industrial computers, point-of-sale (POS) scanners, security and surveillance systems, alarms, automobiles and medical instruments.

Our services consist of pre- and post-sales acoustic tests, audio circuit debugging, audio and voice IC consulting and other total solutions.

Our client base includes: OEM and ODM EMS companies such as Asus, Delta, Foxconn, Flextronics, GPV, Pegatron, Plexus, Sanmina and Wistron; other brands including Advantec, Arçelik, Bosch, Jabil, Matrix, Mitsubishi, MSI, Panasonic, Sakura, Quanta; numerous education and research institutes.

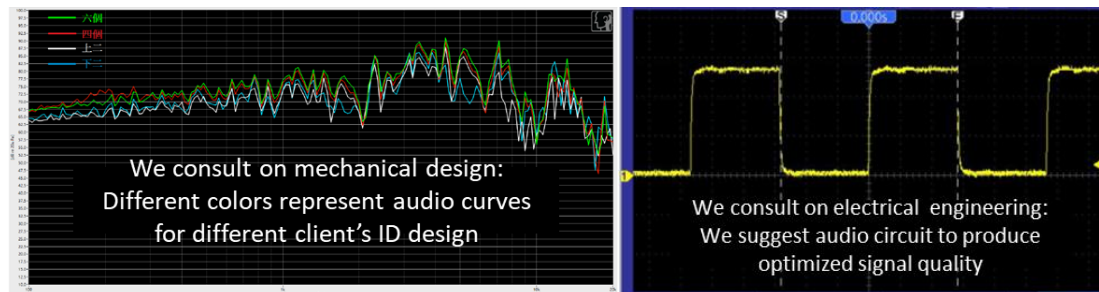

Contact us if you'd expect to...

- 1) Achieve better sound fidelity and higher sound pressure level
- 2) Seek for products that best fit your engineering design and marketing needs
- 3) Design your product enclosure and sound holes to enhance audio resonance
- 4) Fix electrical circuit bugs to eliminate noise and increase signal quality
- 5) Enjoy reasonable price, fast delivery time and reliable supply

Visit aatc.tw or email sales-tp@aatc.tw to learn more



Selection Guide

Glossary

1) Acoustic Overload Point

For a microphone, this indicates the maximum dB of input sound that can be processed by a microphone, with its distortion ratio kept below 10%.

2) Directionality

Omni-directional microphones uniformly receive sound coming from all directions, while uni-directional ones emphasize frontal sound reception.

3) Feedback

If a piezo plate features feedback, users are advised to input signal identical to the predetermined feedback frequency for optimized sound output level.

4) Indicators/ Transducers

An indicator operates on DC source and gives out sound of predetermined tone. A transducer operates on AC source of which signals are externally generated.

5) Rated Frequency or Resonant Frequency

When a transducer, piezo plate, micro-speaker operates at its rated frequency, it emits the highest sound output level compared to other frequencies. For an indicator, it's the default frequency it radiates at when inputted by DC source.

6) Sensitivity

The sensitivity of a microphone represents the strength of electrical signal generated by it, after it receives an audio signal of standardized pressure.

7) Signal/ Noise Ratio

Abbreviated as SNR, this specifies how much useful signal a microphone can output, in comparison to its residual noise.

8) Sound Pressure Level

Abbreviated as SPL, this parameter relates to how loud the sound is. It is often measured in the distance of 10cm or 1m. The unit is logarithmized sound pressure (dB), not sound pressure (Pa).

Product Introduction



Buzzers

Based on how sounds are generated, we have piezo-electric (piezo) and electro-magnetic (magnetic) buzzers. Piezo buzzers rely on high voltage yet consume very little current. On the other hand, magnetic buzzers consume much more current but little voltage. For transducers, users input AC signal and get beeps. Beeps can be intermittent or continual, and can be monotone or multi-tone. However for indicators, users shall send DC signal to activate the oscillators, and get default tones set by AATC.



Micro-speakers

Users can choose from different shapes and sizes of micro-speakers, to fit in their final product. Selection criteria also include operating voltage, input power, sound pressure level and resonant frequencies. Micro-speaker design varies in coil, diaphragm, suspension, basket and magnet etc, each of which are best applicable under certain conditions..



Receivers

Receivers are used in phones and cellphones. Although we provide cutting edge ones, we also manufacture traditional ones such as the SD-150 series, which are often mentioned in phone industry..



Microphones

AATC provides electret condenser microphones (ECM) as the catalogue illustrates, ranging from omni-directional to uni-directional types. For bi-directional ECMs and MEMS microphones, please contact us as they are not in the following catalogue.

Catalogue

Starting from the next page, our catalogue exhibits over one hundred kinds of acoustic products, which are most popular with our clients. For some of them, you may choose to include or exclude wire, change the wire length or mounting type. Drawings of products are measured in mm, and along with pictures they serve only illustration purposes. Audio ICs and amplifiers are not included in this document. [Search online](#) for a more complete and updated catalogue.

Magnetic Buzzers (Transducers)

AC-9F5C

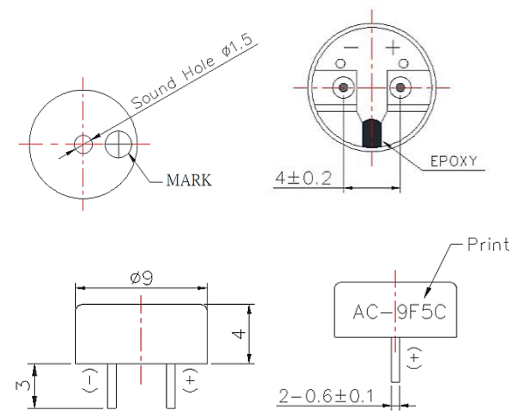

Rated Voltage	(V0p)	5
Operating Voltage	(V0p)	3-7
Consumption Current	(mA)	85
SPL at 10 cm	(dBA)	85
Coil Resistance	(Ω)	40±3
Rated Frequency	(Hz)	2731



AC-9J3C

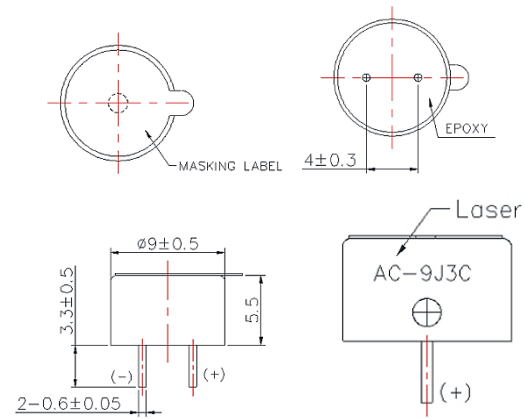

Rated Voltage	(V0p)	3
Operating Voltage	(V0p)	2-4
Consumption Current	(mA)	80
SPL at 10 cm	(dBA)	85
Coil Resistance	(Ω)	15±2
Rated Frequency	(Hz)	2731



AC-9J5C

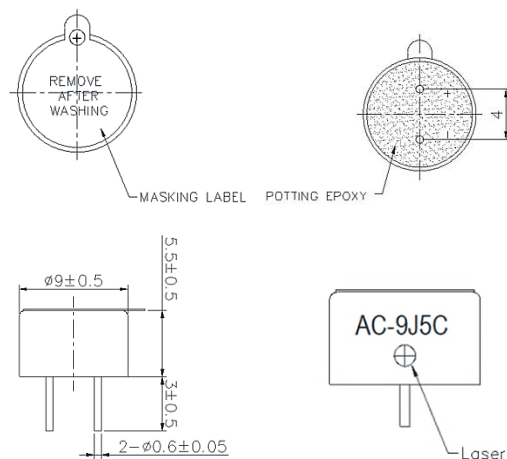

Rated Voltage	(V0p)	5
Operating Voltage	(V0p)	4-6
Consumption Current	(mA)	80
SPL at 10 cm	(dBA)	85
Coil Resistance	(Ω)	30±4.5
Rated Frequency	(Hz)	2731



AC-9J5C1

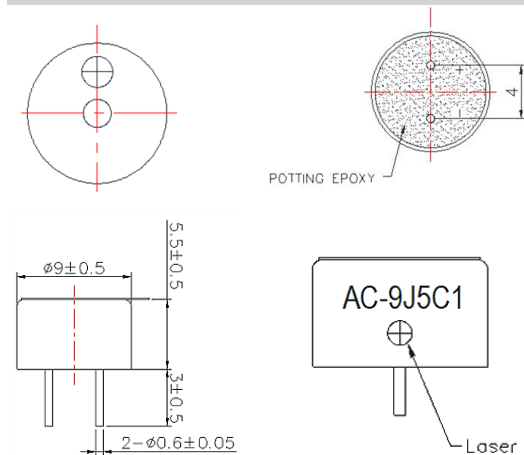

Rated Voltage	(V0p)	5
Operating Voltage	(V0p)	4-6
Consumption Current	(mA)	80
SPL at 10 cm	(dBA)	85
Coil Resistance	(Ω)	30±4.5
Rated Frequency	(Hz)	2731

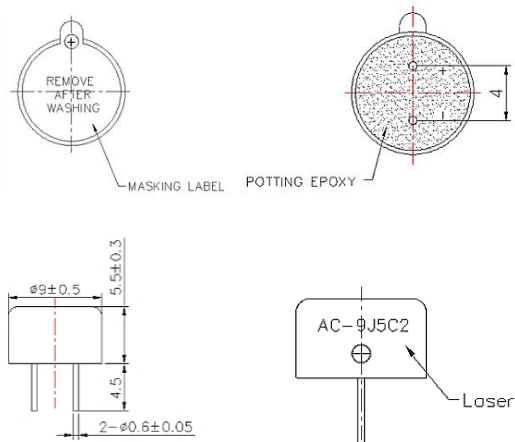

AC-9J5C2

Rated Voltage	(V0p)	5
Operating Voltage	(V0p)	4-8
Consumption Current	(mA)	50
SPL at 10 cm	(dBA)	85
Coil Resistance	(Ω)	40±6
Rated Frequency	(Hz)	2400

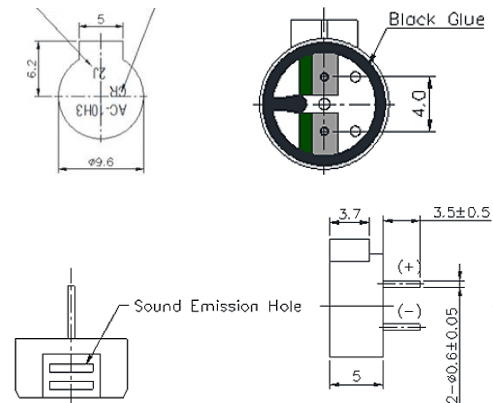
**AC-10H3CR**

Rated Voltage	(V0p)	3
Operating Voltage	(V0p)	2-4
Consumption Current	(mA)	50
SPL at 10 cm	(dBA)	85
Coil Resistance	(Ω)	40±6
Rated Frequency	(Hz)	2730

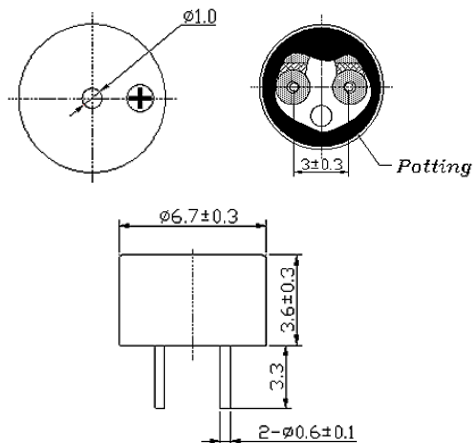
**AC-701S-P1-LF**

Rated Voltage	(V0p)	1.5
Operating Voltage	(V0p)	1-3
Consumption Current	(mA)	80
SPL at 10 cm	(dBA)	70
Coil Resistance	(Ω)	6±1
Rated Frequency	(Hz)	3000

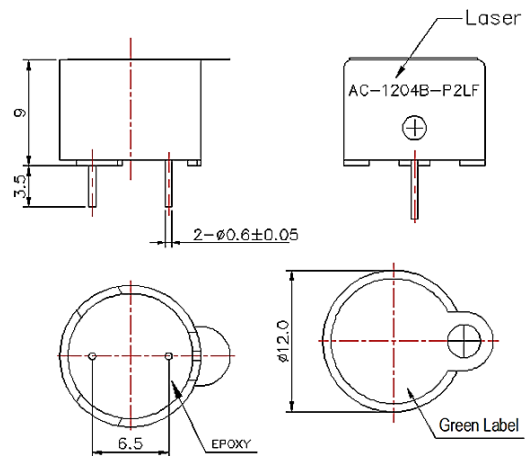
**AC-1204B-P2LF**

Rated Voltage	(V0p)	5
Operating Voltage	(V0p)	3-8
Consumption Current	(mA)	50
SPL at 10 cm	(dBA)	85
Coil Resistance	(Ω)	42±5
Rated Frequency	(Hz)	2048

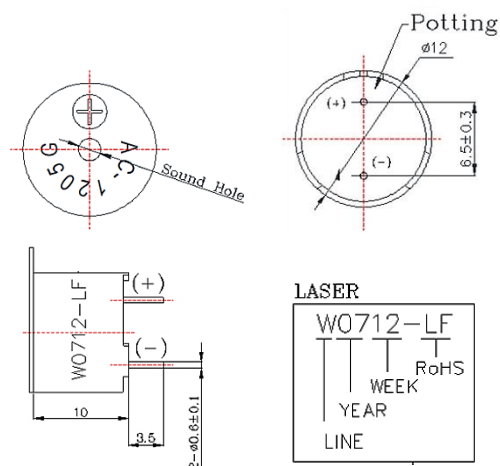

AC-1205G-N1LF

Rated Voltage	(V0p)	5
Operating Voltage	(V0p)	3-8
Consumption Current	(mA)	40
SPL at 10 cm	(dBA)	85
Coil Resistance	(Ω)	40±6
Rated Frequency	(Hz)	2400

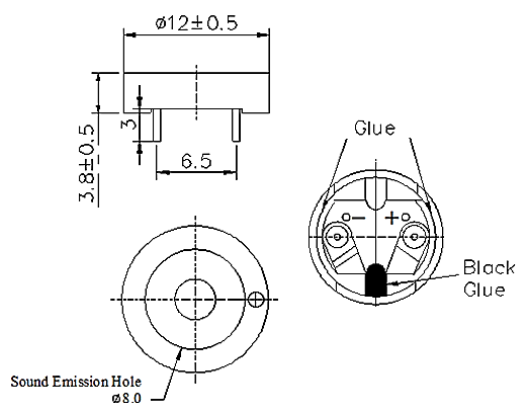
**AC-E12F3A**

Rated Voltage	(V0p)	3
Operating Voltage	(V0p)	2-4
Consumption Current	(mA)	90
SPL at 10 cm	(dBA)	80
Coil Resistance	(Ω)	15±2
Rated Frequency	(Hz)	2048

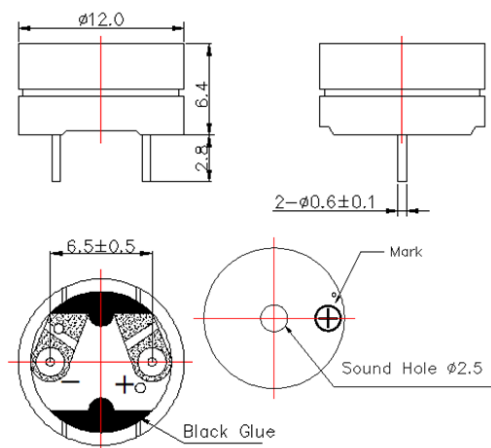
**AS-1201C-1P**

Rated Voltage	(V0p)	1.5
Operating Voltage	(V0p)	1-2
Consumption Current	(mA)	45
SPL at 10 cm	(dBA)	80
Coil Resistance	(Ω)	50±7.5
Rated Frequency	(Hz)	2700

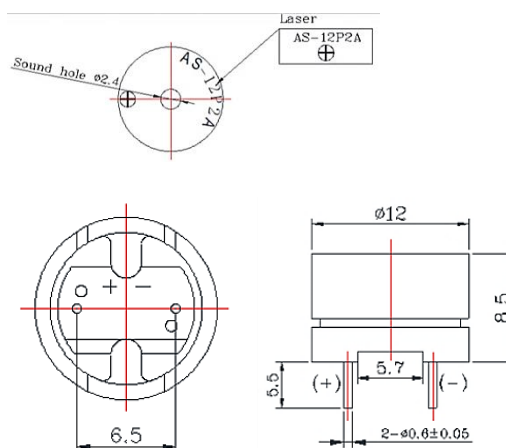
**AS-12P2A**

Rated Voltage	(V0p)	1.5
Operating Voltage	(V0p)	1-3
Consumption Current	(mA)	35
SPL at 10 cm	(dBA)	85
Coil Resistance	(Ω)	16±2.4
Rated Frequency	(Hz)	2048



AC-1405G-LF

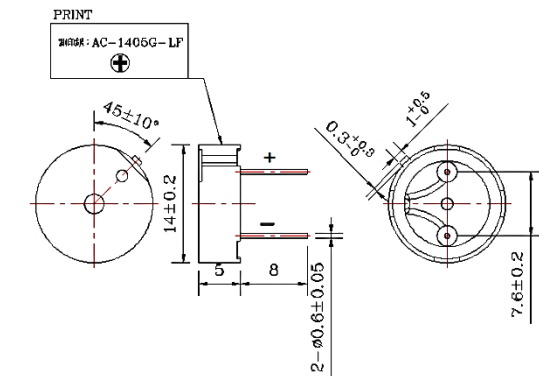

Rated Voltage	(V0p)	5
Operating Voltage	(V0p)	4-6
Consumption Current	(mA)	50
SPL at 10 cm	(dBA)	85
Coil Resistance	(Ω)	40 ± 6
Rated Frequency	(Hz)	2000



AC-1612J-PF

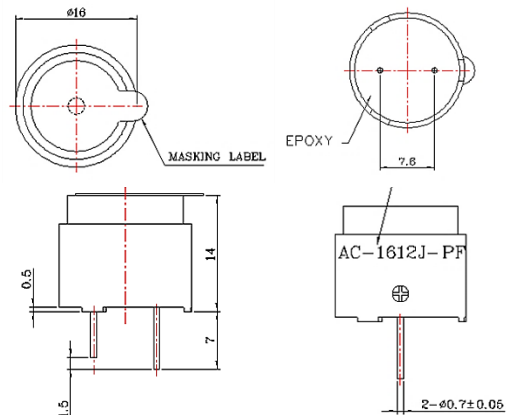

Rated Voltage	(V0p)	12
Operating Voltage	(V0p)	9-15
Consumption Current	(mA)	50
SPL at 10 cm	(dBA)	92
Coil Resistance	(Ω)	115 ± 12
Rated Frequency	(Hz)	2800



AP-1201B-LF

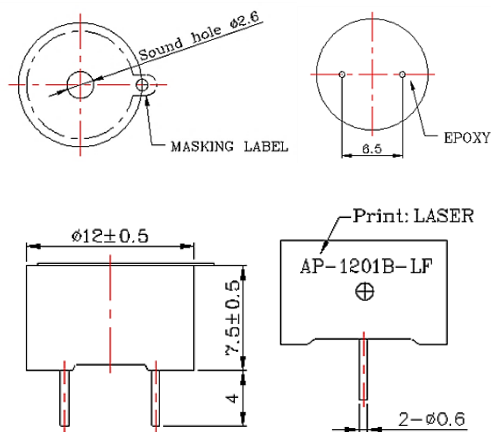

Rated Voltage	(V0p)	1.5
Operating Voltage	(V0p)	1-2
Consumption Current	(mA)	25
SPL at 10 cm	(dBA)	75
Coil Resistance	(Ω)	42 ± 6
Rated Frequency	(Hz)	2048



AD-52A3F

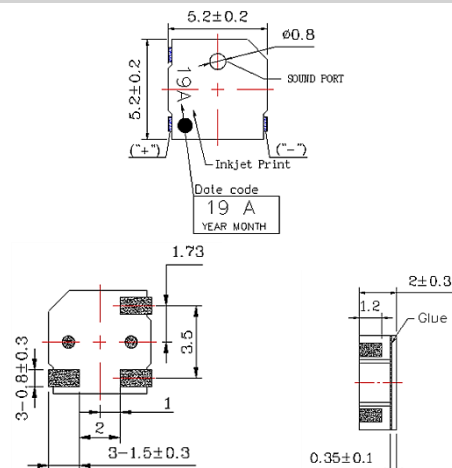

Rated Voltage	(V0p)	3
Operating Voltage	(V0p)	2-4.35
Consumption Current	(mA)	110
SPL at 10 cm	(dBA)	72
Coil Resistance	(Ω)	12 ± 3
Rated Frequency	(Hz)	4000

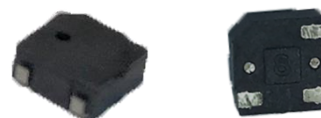

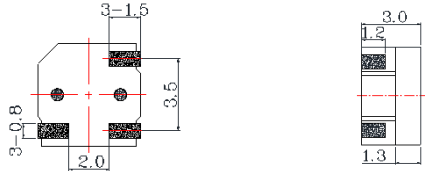
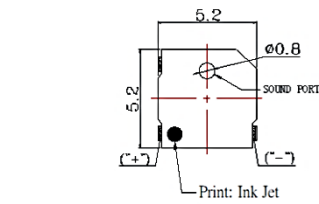
AD-52D3F

Rated Voltage	(V0p)	3
Operating Voltage	(V0p)	2-4
Consumption Current	(mA)	100
SPL at 10 cm	(dBA)	75
Coil Resistance	(Ω)	12 \pm 3
Rated Frequency	(Hz)	4000

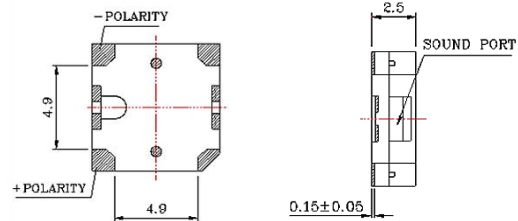
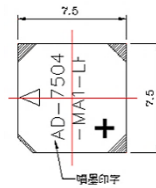
**AD-7504-MA1-LF**

Rated Voltage	(V0p)	3.6
Operating Voltage	(V0p)	2.5-4.5
Consumption Current	(mA)	150
SPL at 10 cm	(dBA)	80
Coil Resistance	(Ω)	10 \pm 2
Rated Frequency	(Hz)	2500

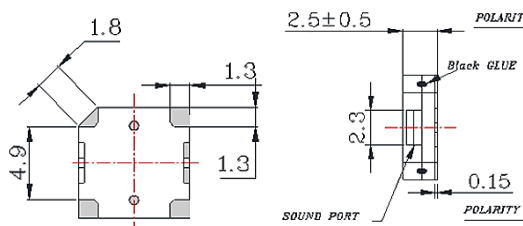
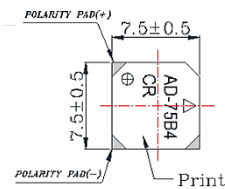
**AD-75B4CR**

Rated Voltage	(V0p)	3.6
Operating Voltage	(V0p)	2.5-4.5
Consumption Current	(mA)	100
SPL at 10 cm	(dBA)	82
Coil Resistance	(Ω)	15 \pm 3
Rated Frequency	(Hz)	2730

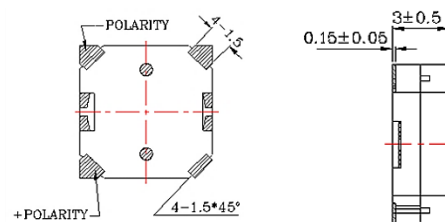
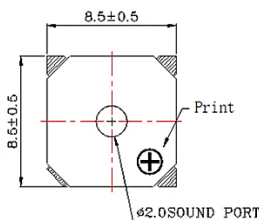
**AD-8505-PQ1-1**

Rated Voltage	(V0p)	5
Operating Voltage	(V0p)	3-6
Consumption Current	(mA)	100
SPL at 10 cm	(dBA)	87
Coil Resistance	(Ω)	12 \pm 3
Rated Frequency	(Hz)	4000



AD-85D4CR

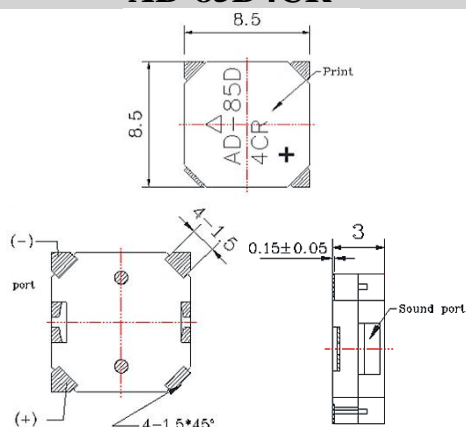

Rated Voltage	(V0p)	3.6
Operating Voltage	(V0p)	2.5-4.5
Consumption Current	(mA)	100
SPL at 10 cm	(dBA)	85
Coil Resistance	(Ω)	16±3
Rated Frequency	(Hz)	2730



AD-85D4FR

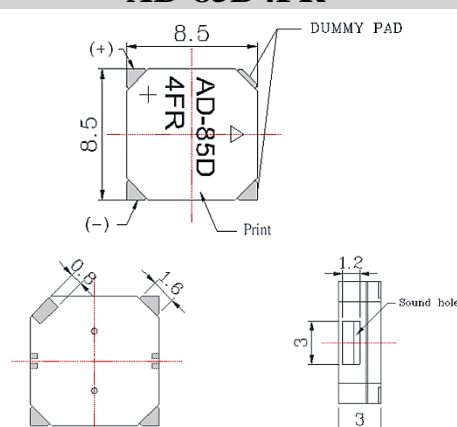

Rated Voltage	(V0p)	3.6
Operating Voltage	(V0p)	2.5-4.5
Consumption Current	(mA)	100
SPL at 10 cm	(dBA)	90
Coil Resistance	(Ω)	16±3
Rated Frequency	(Hz)	4000



AV-9D3CR

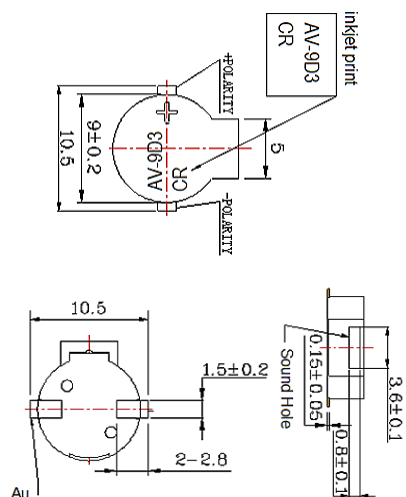

Rated Voltage	(V0p)	3
Operating Voltage	(V0p)	2-4
Consumption Current	(mA)	100
SPL at 10 cm	(dBA)	80
Coil Resistance	(Ω)	15±3
Rated Frequency	(Hz)	2730



AV-9D5CR

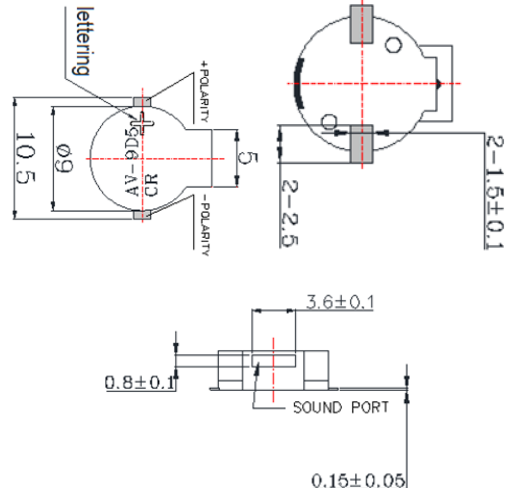

Rated Voltage	(V0p)	5
Operating Voltage	(V0p)	3-8
Consumption Current	(mA)	80
SPL at 10 cm	(dBA)	85
Coil Resistance	(Ω)	30±5
Rated Frequency	(Hz)	2731



Magnetic Buzzers (Indicators)

AI-10H3C

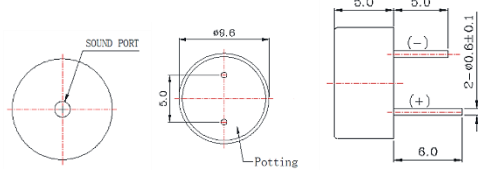

PRINT: Laser & Date code (Ex. 2015.07)

AI-10H3C

⊕ 15G
Year 2015
Month (A-L)

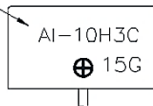

Rated Voltage	(VDC)	3
Operating Voltage	(VDC)	2-5
Consumption Current	(mA)	30
SPL at 10 cm	(dBA)	80
Response Time	(ms)	100
Rated Frequency	(Hz)	2700



AI-10H5C

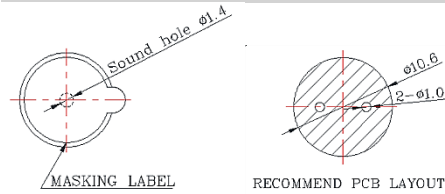

RECOMMEND PCB LAYOUT

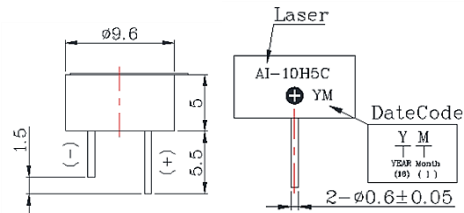

Rated Voltage	(VDC)	5
Operating Voltage	(VDC)	3-7
Consumption Current	(mA)	30
SPL at 10 cm	(dBA)	80
Response Time	(ms)	100
Rated Frequency	(Hz)	2700



AI-12M5B1

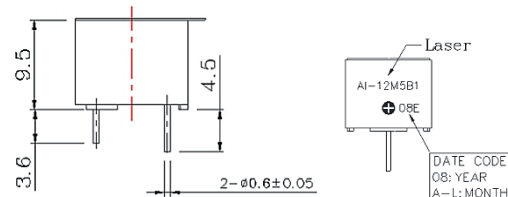
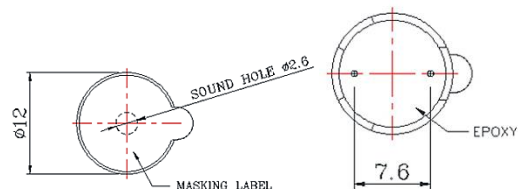

Rated Voltage	(VDC)	5
Operating Voltage	(VDC)	4-7
Consumption Current	(mA)	35
SPL at 10 cm	(dBA)	85
Response Time	(ms)	100
Rated Frequency	(Hz)	2300



AI-12M12B

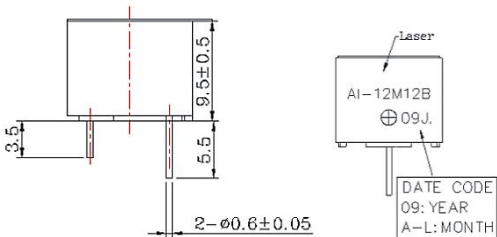
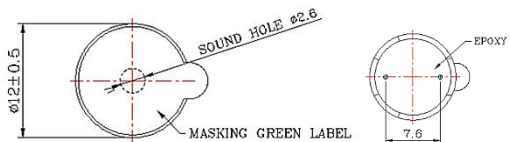

Rated Voltage	(VDC)	12
Operating Voltage	(VDC)	8-16
Consumption Current	(mA)	35
SPL at 10 cm	(dBA)	85
Response Time	(ms)	100
Rated Frequency	(Hz)	2300

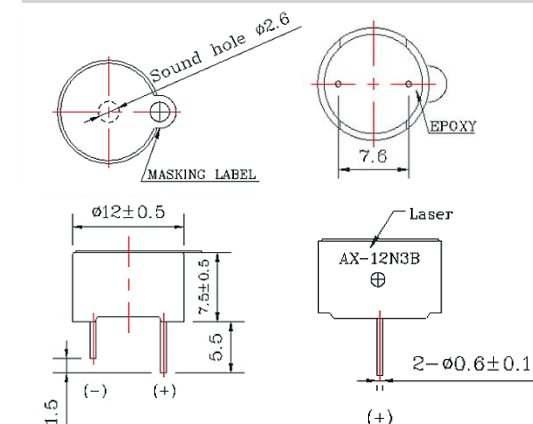

AX-12N3B

Rated Voltage	(VDC)	3
Operating Voltage	(VDC)	2-5
Consumption Current	(mA)	30
SPL at 10 cm	(dBA)	80
Response Time	(ms)	100
Rated Frequency	(Hz)	2300

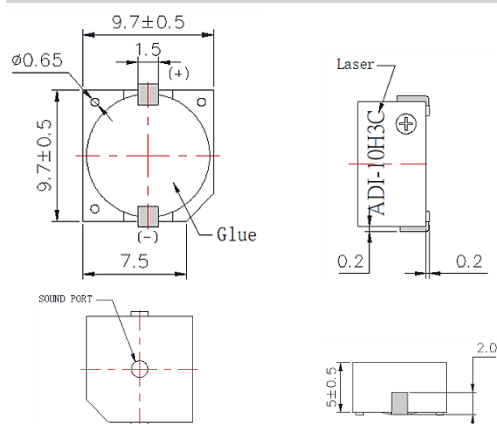
**ADI-10H3C**

Rated Voltage	(VDC)	3
Operating Voltage	(VDC)	2-5
Consumption Current	(mA)	30
SPL at 10 cm	(dBA)	80
Response Time	(ms)	100
Rated Frequency	(Hz)	2700

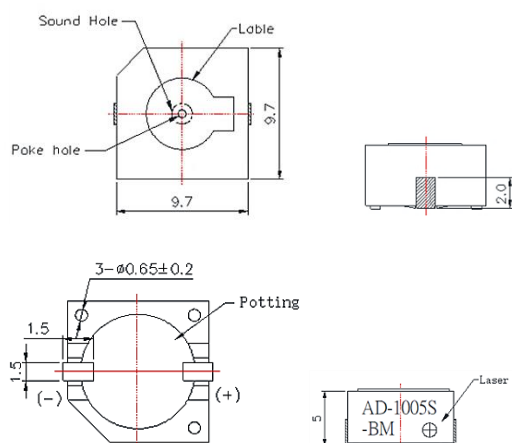
**AD-1005S-BM**

Rated Voltage	(VDC)	5
Operating Voltage	(VDC)	4-7
Consumption Current	(mA)	30
SPL at 10 cm	(dBA)	80
Response Time	(ms)	100
Rated Frequency	(Hz)	2700

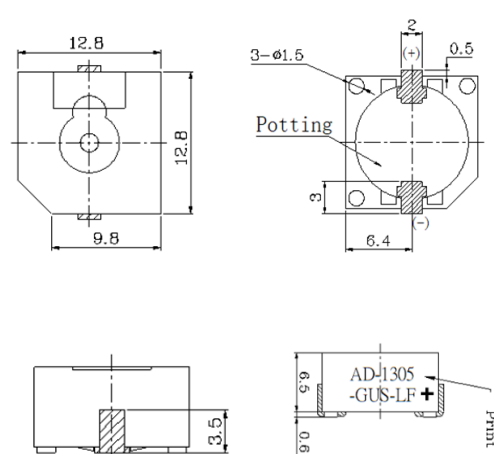
**AD-1305-GUS-LF**

Rated Voltage	(VDC)	5
Operating Voltage	(VDC)	4-7
Consumption Current	(mA)	30
SPL at 10 cm	(dBA)	88
Response Time	(ms)	100
Rated Frequency	(Hz)	2400

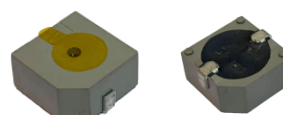

Piezo Buzzers (Transducers)

AZ-1340E-2WV

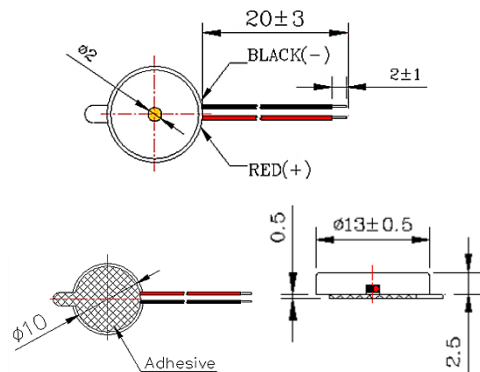

Rated Voltage	(Vpp)	5
Operating Voltage	(Vpp)	1-25
Consumption Current	(mA)	5
SPL at 10 cm	(dBA)	78
Capacitance	(pF)	10000±30%
Rated Frequency	(Hz)	4000



AZ-1348E-6WV

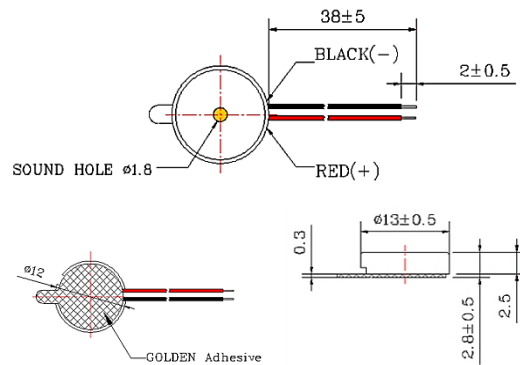

Rated Voltage	(Vpp)	10
Operating Voltage	(Vpp)	1-25
Consumption Current	(mA)	5
SPL at 10 cm	(dBA)	80
Capacitance	(pF)	14000±30%
Rated Frequency	(Hz)	4800



AZ-14M40

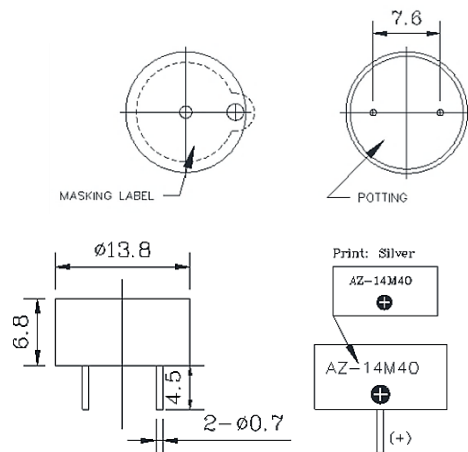

Rated Voltage	(Vpp)	5
Operating Voltage	(Vpp)	1-30
Consumption Current	(mA)	5
SPL at 10 cm	(dBA)	80
Capacitance	(pF)	13000±30%
Rated Frequency	(Hz)	4000



AZ-1640E-WV8-1

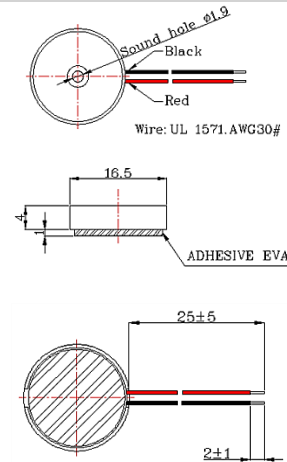

Rated Voltage	(Vpp)	9
Operating Voltage	(Vpp)	1-30
Consumption Current	(mA)	7
SPL at 10 cm	(dBA)	80
Capacitance	(pF)	15000±30%
Rated Frequency	(Hz)	4000



AZ-1740E-2P

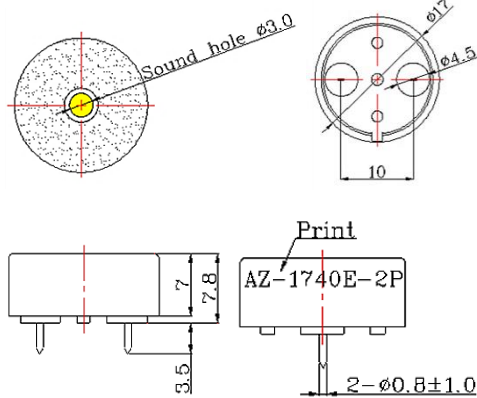

Rated Voltage	(Vpp)	5
Operating Voltage	(Vpp)	1-30
Consumption Current	(mA)	3
SPL at 10 cm	(dBA)	80
Capacitance	(pF)	15000 $\pm 30\%$
Rated Frequency	(Hz)	4000



AZ-3035E-W1-LF

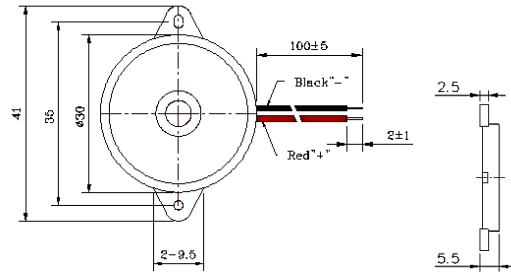

Rated Voltage	(Vpp)	9
Operating Voltage	(Vpp)	1-30
Consumption Current	(mA)	8
SPL at 10 cm	(dBA)	88
Capacitance	(pF)	20000 $\pm 30\%$
Rated Frequency	(Hz)	3500



AZ-4409E-W1

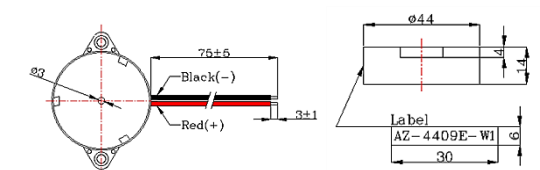
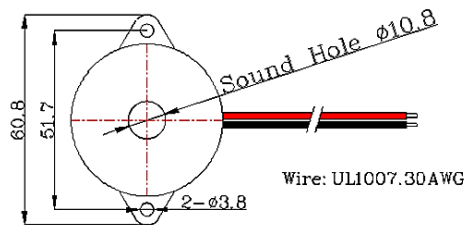

Rated Voltage	(Vpp)	9
Operating Voltage	(Vpp)	1-30
Consumption Current	(mA)	3
SPL at 10 cm	(dBA)	85
Capacitance	(pF)	70000 $\pm 30\%$
Rated Frequency	(Hz)	900



AZ-4720E-W-LF

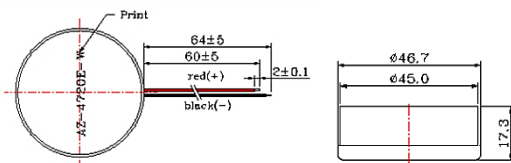
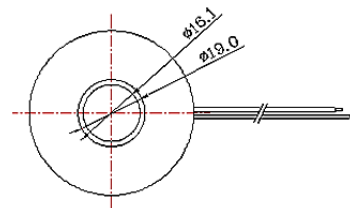

Rated Voltage	(Vpp)	10
Operating Voltage	(Vpp)	1-30
Consumption Current	(mA)	30
SPL at 10 cm	(dBA)	90
Capacitance	(pF)	15000 $\pm 30\%$
Rated Frequency	(Hz)	2500



Piezo Buzzers (Indicators/ Sirens)

AZ-2329S-P-LF

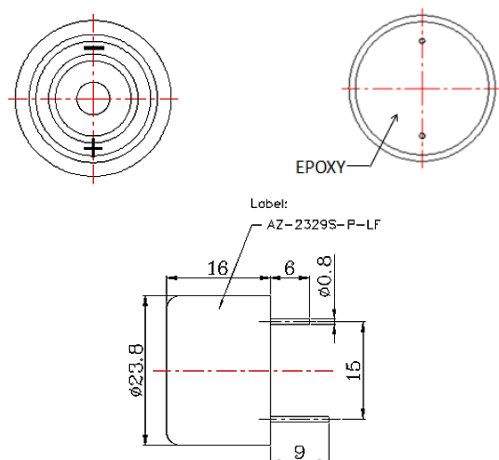

Rated Voltage	(VDC)	12
Operating Voltage	(VDC)	3-20
Consumption Current	(mA)	8
SPL at 10 cm	(dBA)	85
Response Time	(ms)	100
Rated Frequency	(Hz)	2900



AZ-2335S-1P

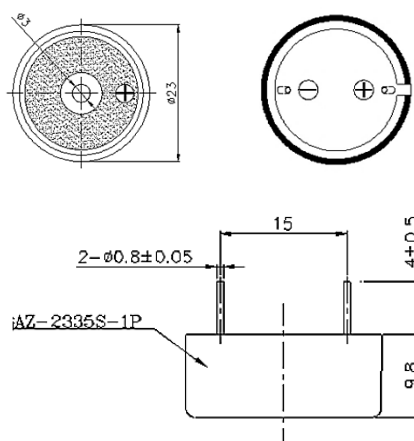

Rated Voltage	(VDC)	12
Operating Voltage	(VDC)	1.5-28
Consumption Current	(mA)	10
SPL at 10 cm	(dBA)	90
Response Time	(ms)	100
Rated Frequency	(Hz)	3500



AZ-2434S-PD

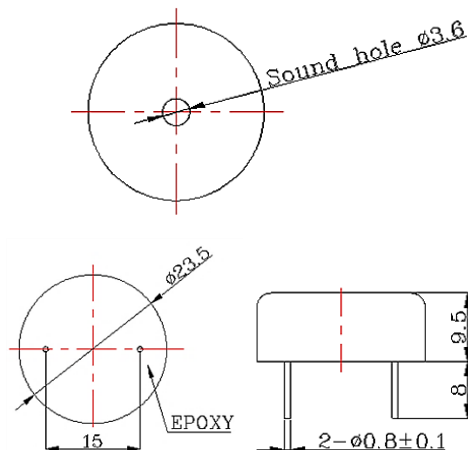

Rated Voltage	(VDC)	12
Operating Voltage	(VDC)	3-20
Consumption Current	(mA)	10
SPL at 10 cm	(dBA)	95
Response Time	(ms)	100
Rated Frequency	(Hz)	3400



AZ-3035S-3C

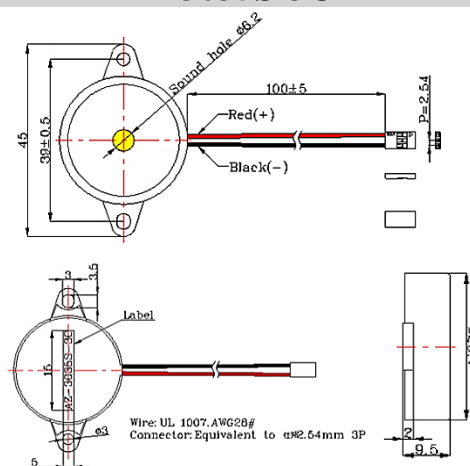

Rated Voltage	(VDC)	12
Operating Voltage	(VDC)	5-15
Consumption Current	(mA)	20
SPL at 10 cm	(dBA)	95
Response Time	(ms)	100
Rated Frequency	(Hz)	3500

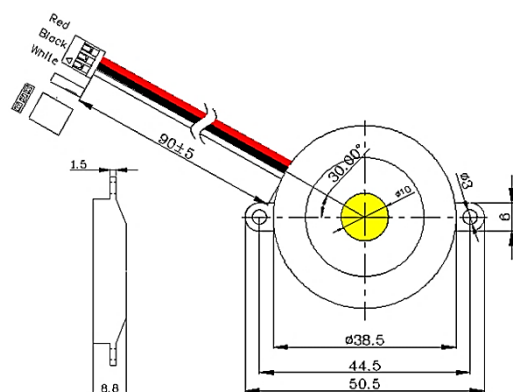

AZ-3828S-C

Rated Voltage	(VDC)	9
Operating Voltage	(VDC)	3-24
Consumption Current	(mA)	10
SPL at 10 cm	(dBA)	80
Response Time	(ms)	100
Rated Frequency	(Hz)	2800

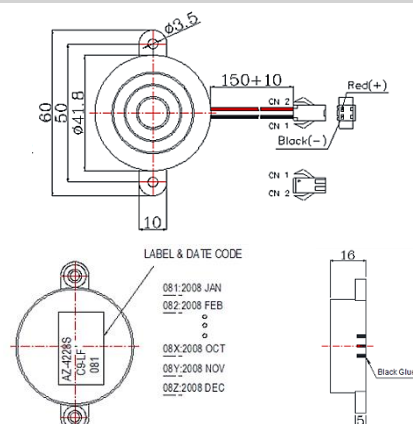
**AZ-4228S-C9-LF**

Rated Voltage	(VDC)	12
Operating Voltage	(VDC)	3-28
Consumption Current	(mA)	9
SPL at 10 cm	(dBA)	85
Response Time	(ms)	100
Rated Frequency	(Hz)	2800

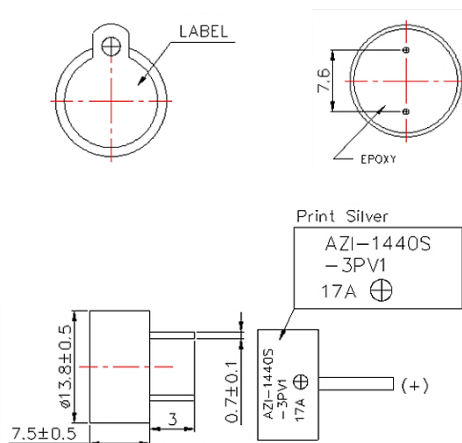
**AZI-1440S-3PV1**

Rated Voltage	(VDC)	12
Operating Voltage	(VDC)	3.5-16
Consumption Current	(mA)	15
SPL at 10 cm	(dBA)	85
Response Time	(ms)	100
Rated Frequency	(Hz)	4000

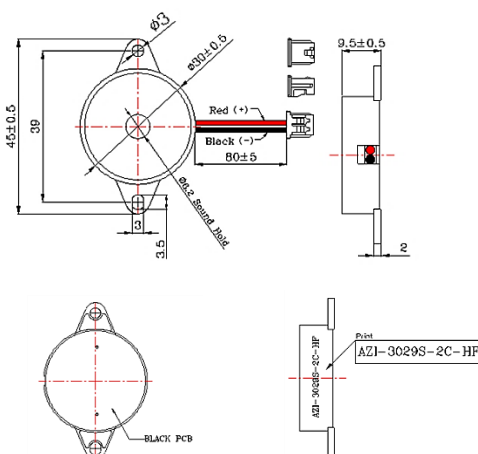
**AZI-3029S-2C-HF**

Rated Voltage	(VDC)	18
Operating Voltage	(VDC)	15-23
Consumption Current	(mA)	20
SPL at 10 cm	(dBA)	100
Response Time	(ms)	100
Rated Frequency	(Hz)	2900



Piezo Plates

AE-1560E-WV3

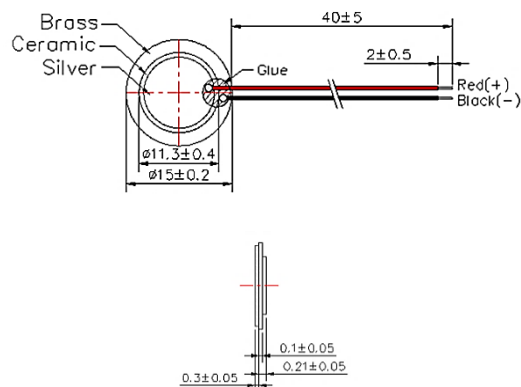

Input Voltage (Vpp Max)	30
Capacitance (pF)	14000±30%
Plate Material	Brass
Feedback	No
Resonant Impedance (Ω Max)	300
Resonant Frequency (Hz)	6000



AE-2038E-4WA

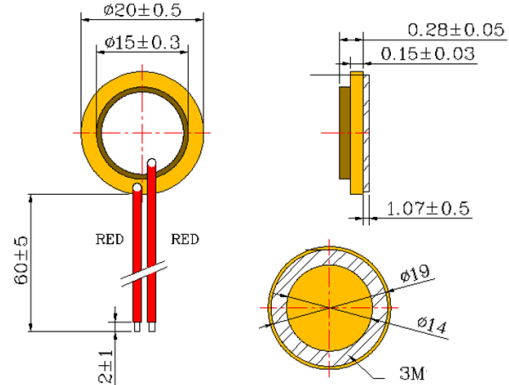

Input Voltage (Vpp Max)	20
Capacitance (pF)	25000±30%
Plate Material	Brass
Feedback	No
Resonant Impedance (Ω Max)	300
Resonant Frequency (Hz)	3800



AE-2746E-N1

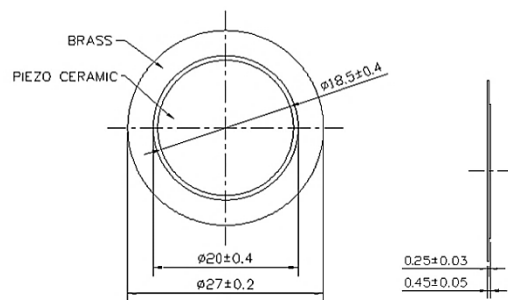

Input Voltage (Vpp Max)	30
Capacitance (pF)	20000±30%
Plate Material	Brass
Feedback	No
Resonant Impedance (Ω Max)	300
Resonant Frequency (Hz)	4600



AE-3529F-1C

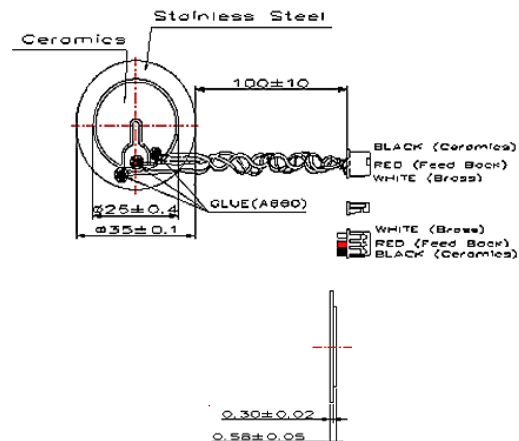

Input Voltage (Vpp Max)	30
Capacitance (pF)	28000±30%
Plate Material	Brass
Feedback	Yes
Resonant Impedance (Ω Max)	300
Resonant Frequency (Hz)	2900



Micro-Speakers (Circular)

AK-1006A-1W

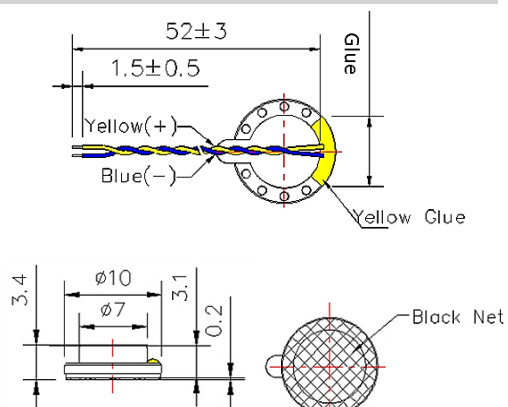

Rated Input Power	(W)	0.3
Max Input Power	(W)	0.5
SPL at 10 cm	(dBA)	85
Impedance	(Ω)	6±15%
Rated Frequency	(Hz)	1200
Frequency Range	(Hz)	1200-7k



AK-150805-PM-2W

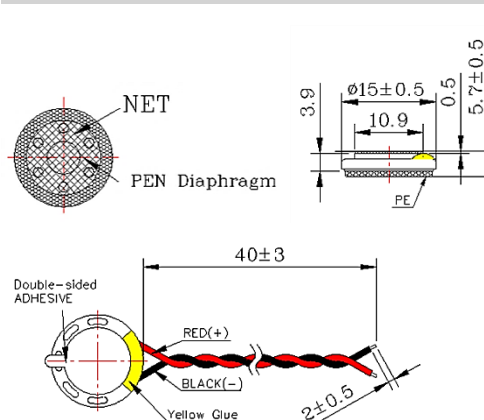

Rated Input Power	(W)	0.5
Max Input Power	(W)	1.0
SPL at 10 cm	(dBA)	96
Impedance	(Ω)	8±15%
Rated Frequency	(Hz)	1350
Frequency Range	(Hz)	1350-20k



AK-170810-PM-1W

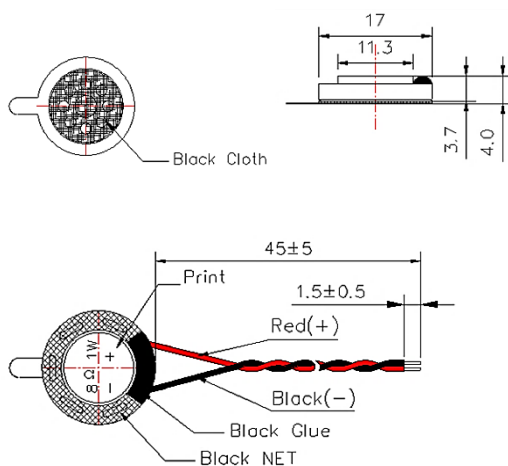

Rated Input Power	(W)	1.0
Max Input Power	(W)	1.5
SPL at 10 cm	(dBA)	95
Impedance	(Ω)	8±15%
Rated Frequency	(Hz)	900
Frequency Range	(Hz)	900-10k



AK-180810-PM-1W

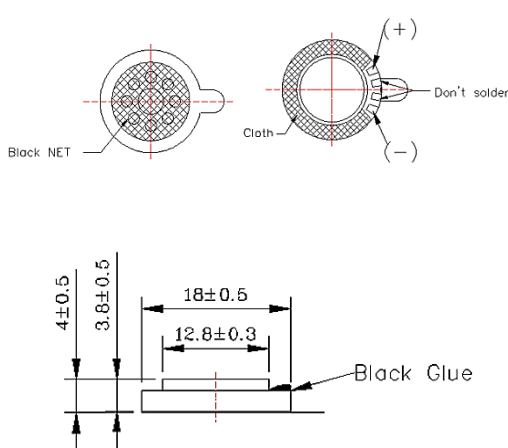

Rated Input Power	(W)	1.0
Max Input Power	(W)	1.2
SPL at 10 cm	(dBA)	92
Impedance	(Ω)	8±15%
Rated Frequency	(Hz)	1000
Frequency Range	(Hz)	1000-5k

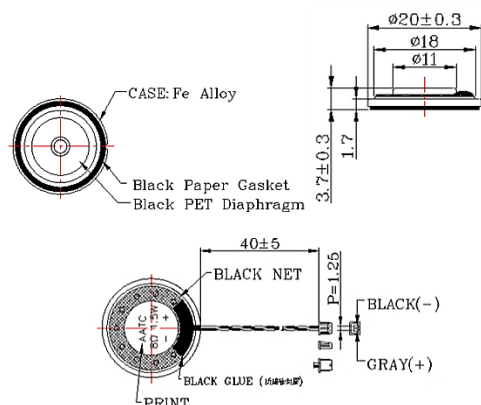

AK-2008EB-43C4

Rated Input Power	(W)	1.5
Max Input Power	(W)	2.0
SPL at 10 cm	(dBA)	97
Impedance	(Ω)	$8 \pm 15\%$
Rated Frequency	(Hz)	1100
Frequency Range	(Hz)	1100-20k

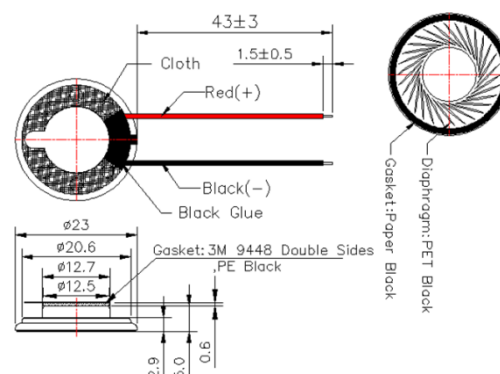
**AK-230810-MM-2W1**

Rated Input Power	(W)	1.0
Max Input Power	(W)	1.5
SPL at 10 cm	(dBA)	96
Impedance	(Ω)	$8 \pm 15\%$
Rated Frequency	(Hz)	750
Frequency Range	(Hz)	750-20k

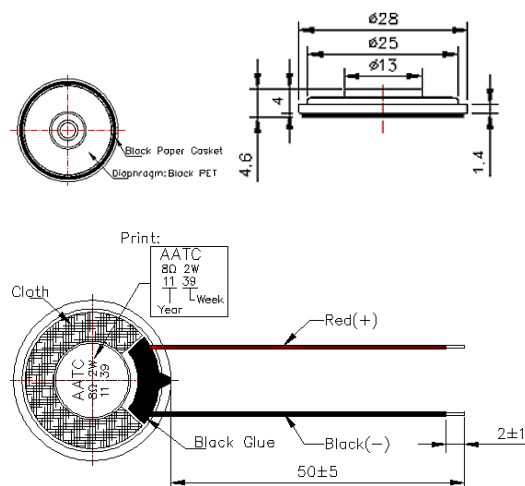
**AK-M28M8-2W**

Rated Input Power	(W)	2.0
Max Input Power	(W)	2.5
SPL at 10 cm	(dBA)	97
Impedance	(Ω)	$8 \pm 15\%$
Rated Frequency	(Hz)	650
Frequency Range	(Hz)	650-8k

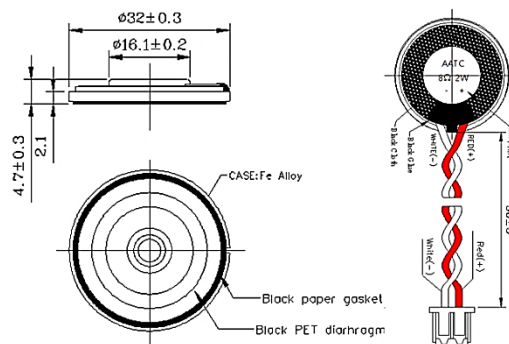
**AK-3208BB-2C**

Rated Input Power	(W)	2.0
Max Input Power	(W)	2.5
SPL at 10 cm	(dBA)	100
Impedance	(Ω)	$8 \pm 15\%$
Rated Frequency	(Hz)	550
Frequency Range	(Hz)	550-20k



AK-3608BB-17C5

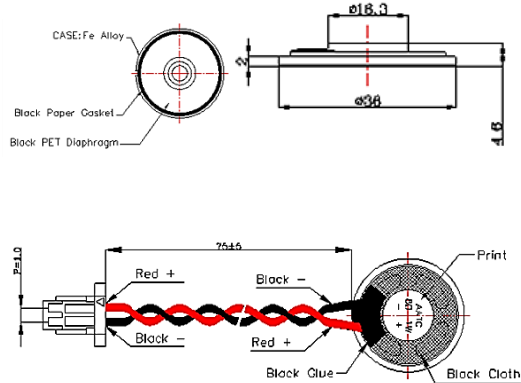

Rated Input Power	(W)	1.0
Max Input Power	(W)	1.2
SPL at 10 cm	(dBA)	102
Impedance	(Ω)	8±15%
Rated Frequency	(Hz)	550
Frequency Range	(Hz)	550-6k



AK-M36M8-2C

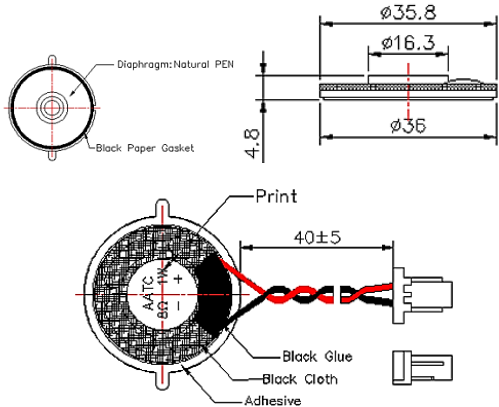

Rated Input Power	(W)	1.0
Max Input Power	(W)	1.5
SPL at 10 cm	(dBA)	101
Impedance	(Ω)	8±15%
Rated Frequency	(Hz)	650
Frequency Range	(Hz)	650-12k



AK-400420-MM-1C

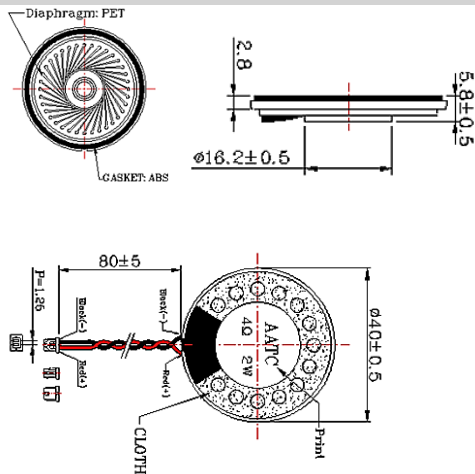

Rated Input Power	(W)	2.0
Max Input Power	(W)	3.0
SPL at 10 cm	(dBA)	104
Impedance	(Ω)	4±15%
Rated Frequency	(Hz)	600
Frequency Range	(Hz)	600-5k



AK-4004BF-2

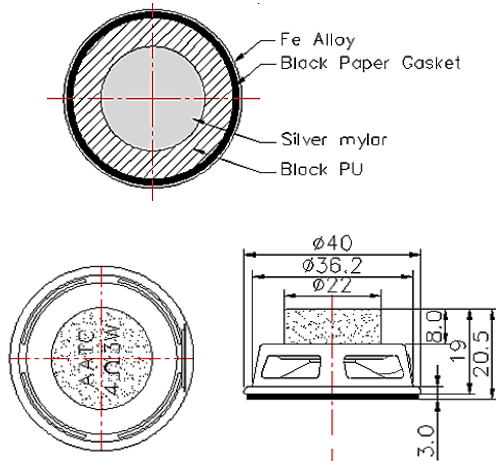

Rated Input Power	(W)	3.0
Max Input Power	(W)	5.0
SPL at 10 cm	(dBA)	101
Impedance	(Ω)	4±15%
Rated Frequency	(Hz)	250
Frequency Range	(Hz)	250-20k

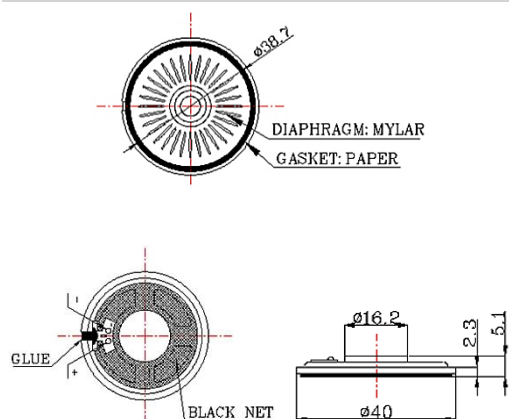

AK-4008BB-6-LF

Rated Input Power	(W)	1.0
Max Input Power	(W)	1.5
SPL at 10 cm	(dBA)	102
Impedance	(Ω)	$8 \pm 15\%$
Rated Frequency	(Hz)	600
Frequency Range	(Hz)	600-6k

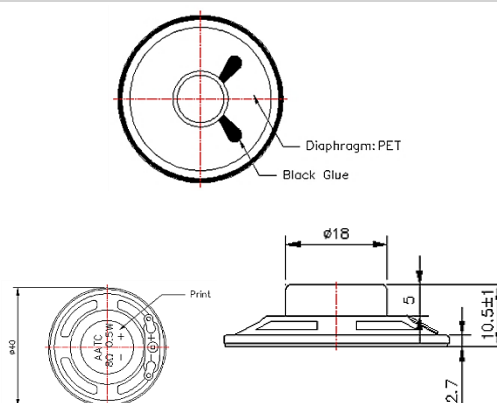
**AK-400805-MM-2**

Rated Input Power	(W)	0.5
Max Input Power	(W)	1.0
SPL at 10 cm	(dBA)	98
Impedance	(Ω)	$8 \pm 15\%$
Rated Frequency	(Hz)	800
Frequency Range	(Hz)	800-5k

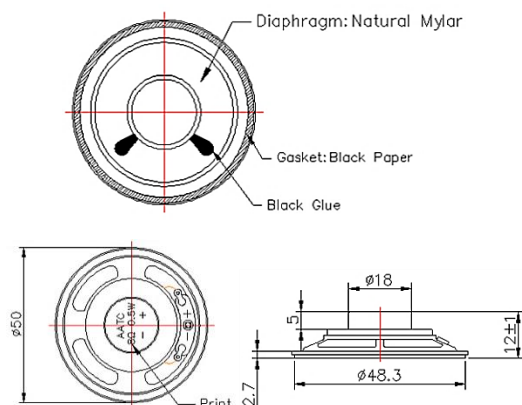
**AK-500805-MM-1**

Rated Input Power	(W)	0.5
Max Input Power	(W)	1.0
SPL at 10 cm	(dBA)	100
Impedance	(Ω)	$8 \pm 15\%$
Rated Frequency	(Hz)	750
Frequency Range	(Hz)	750-4.5k

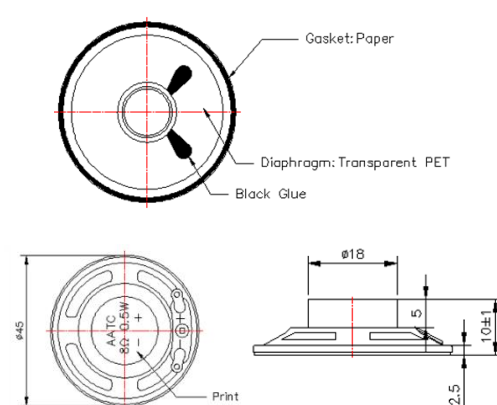
**AK-450805-MM-1**

Rated Input Power	(W)	0.5
Max Input Power	(W)	1.0
SPL at 10 cm	(dBA)	98
Impedance	(Ω)	$8 \pm 15\%$
Rated Frequency	(Hz)	650
Frequency Range	(Hz)	650-7k

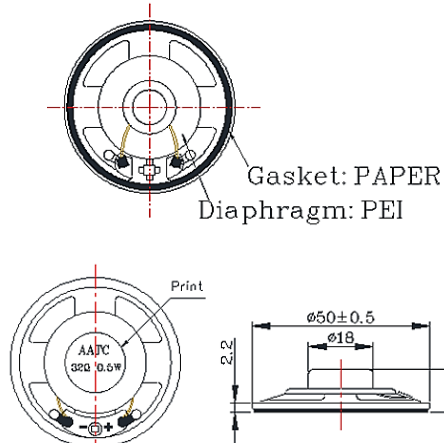

AK-503205-MM-1

Rated Input Power	(W)	0.5
Max Input Power	(W)	1.0
SPL at 10 cm	(dBA)	96
Impedance	(Ω)	32±15%
Rated Frequency	(Hz)	550
Frequency Range	(Hz)	550-4k

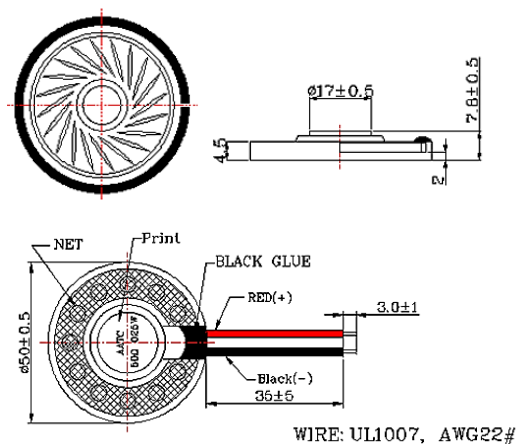
**AK-5050025-PM-1W**

Rated Input Power	(W)	0.25
Max Input Power	(W)	0.50
SPL at 10 cm	(dBA)	97
Impedance	(Ω)	50±15%
Rated Frequency	(Hz)	400
Frequency Range	(Hz)	400-3.5k

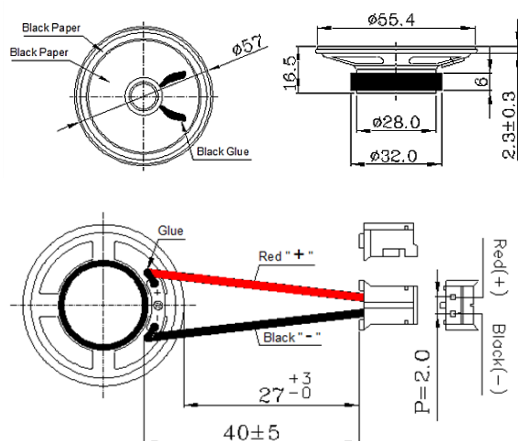
**AK-5708YC-1C**

Rated Input Power	(W)	0.5
Max Input Power	(W)	0.8
SPL at 10 cm	(dBA)	94
Impedance	(Ω)	8±15%
Rated Frequency	(Hz)	500
Frequency Range	(Hz)	500-5k

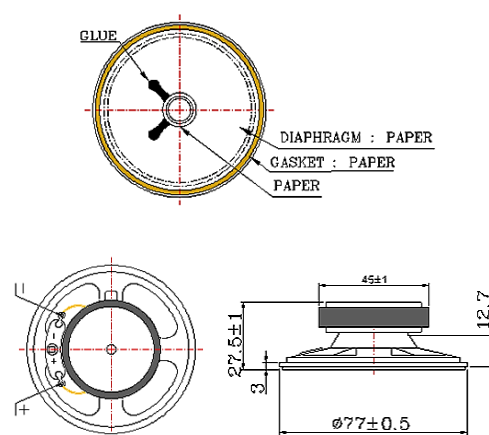
**AK-770820-MP-1**

Rated Input Power	(W)	2.0
Max Input Power	(W)	3.0
SPL at 10 cm	(dBA)	110
Impedance	(Ω)	8±15%
Rated Frequency	(Hz)	340
Frequency Range	(Hz)	340-2k



Micro-Speakers (Oval/ Rectangular)

AKV-15100805-PM-1C

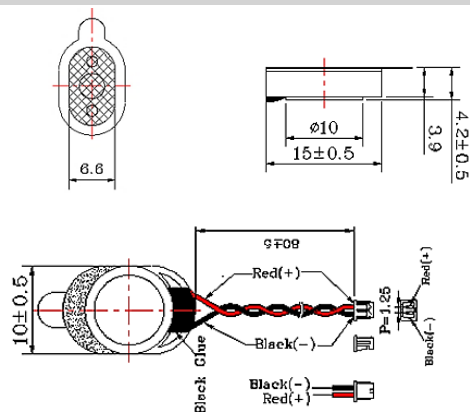

Rated Input Power	(W)	0.5
Max Input Power	(W)	0.8
SPL at 10 cm	(dBA)	86
Impedance	(Ω)	8±15%
Rated Frequency	(Hz)	1300
Frequency Range	(Hz)	1300-20k



AKR-151107D-1P

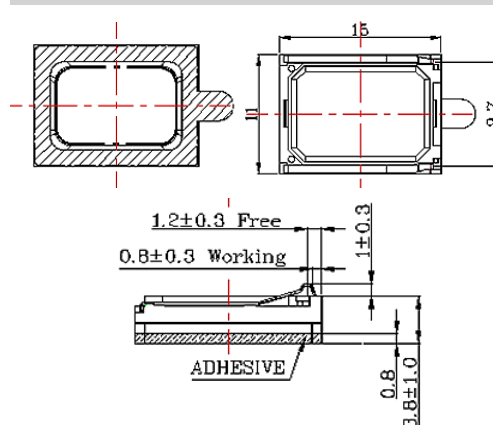

Rated Input Power	(W)	0.6
Max Input Power	(W)	1.0
SPL at 10 cm	(dBA)	83
Impedance	(Ω)	7±15%
Rated Frequency	(Hz)	600
Frequency Range	(Hz)	600-20k



AKV-20140408-PM-1C

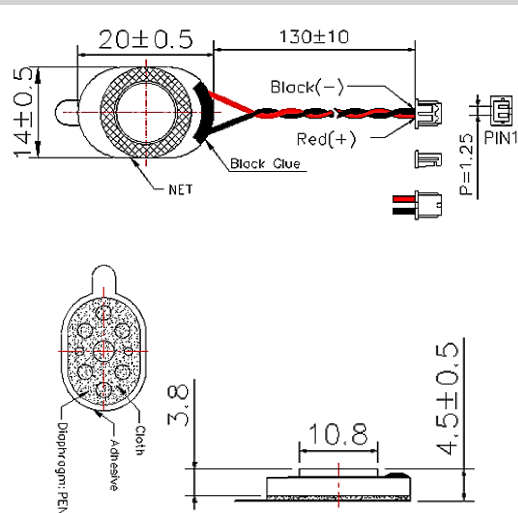

Rated Input Power	(W)	0.8
Max Input Power	(W)	1.0
SPL at 10 cm	(dBA)	94
Impedance	(Ω)	4±15%
Rated Frequency	(Hz)	950
Frequency Range	(Hz)	950-20k



AKV-24150808-PM-1W

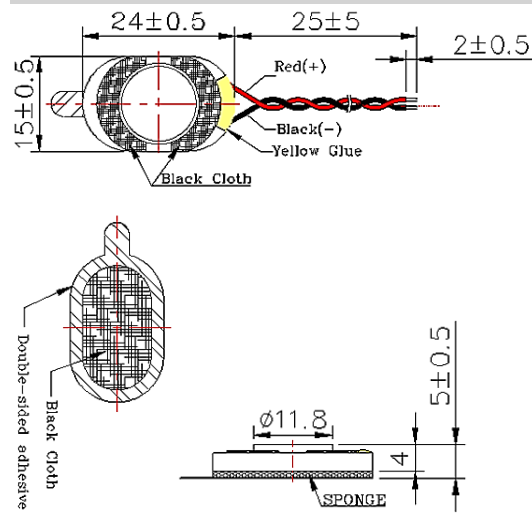

Rated Input Power	(W)	0.8
Max Input Power	(W)	1.2
SPL at 10 cm	(dBA)	92
Impedance	(Ω)	8±15%
Rated Frequency	(Hz)	950
Frequency Range	(Hz)	950-6k

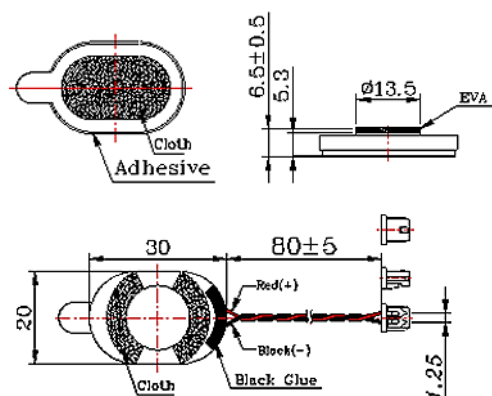

AKV-P3020M4-1C

Rated Input Power	(W)	1.0
Max Input Power	(W)	1.2
SPL at 10 cm	(dBA)	95
Impedance	(Ω)	4±15%
Rated Frequency	(Hz)	750
Frequency Range	(Hz)	750-5k

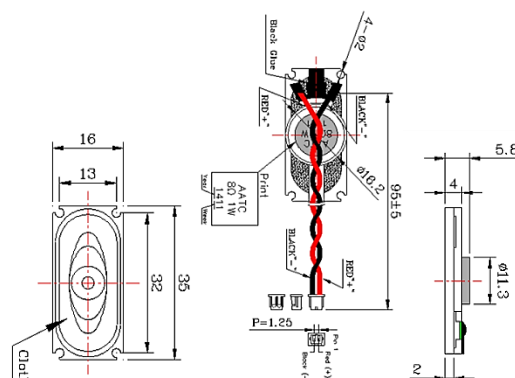
**AK-351608EC-8C**

Rated Input Power	(W)	1.0
Max Input Power	(W)	2.0
SPL at 10 cm	(dBA)	95
Impedance	(Ω)	8±15%
Rated Frequency	(Hz)	720
Frequency Range	(Hz)	720-20k

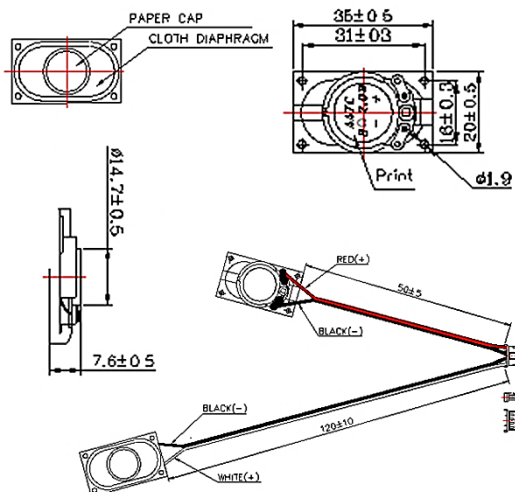
**AKR-35200820-PPC-1C**

Rated Input Power	(W)	2.0
Max Input Power	(W)	3.0
SPL at 10 cm	(dBA)	97
Impedance	(Ω)	8±15%
Rated Frequency	(Hz)	850
Frequency Range	(Hz)	850-10k

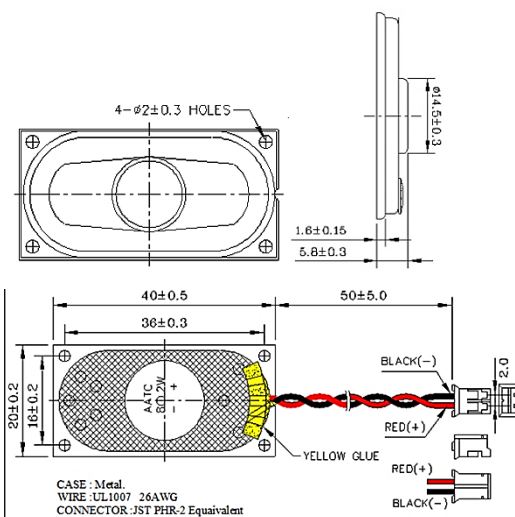
**AK-402008CC-6C7**

Rated Input Power	(W)	2.0
Max Input Power	(W)	3.0
SPL at 10 cm	(dBA)	95
Impedance	(Ω)	8±15%
Rated Frequency	(Hz)	400
Frequency Range	(Hz)	400-2.2k



AKR-535308100-MU-1C2

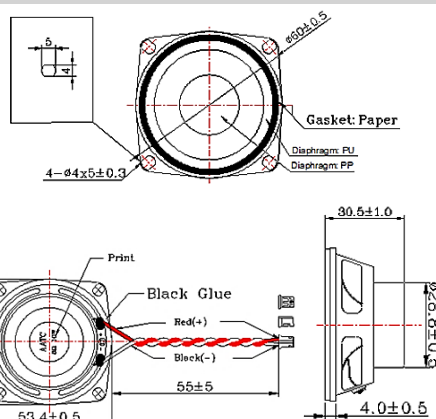

Rated Input Power	(W)	10.0
Max Input Power	(W)	15.0
SPL at 10 cm	(dBA)	121
Impedance	(Ω)	8 \pm 15%
Rated Frequency	(Hz)	200
Frequency Range	(Hz)	200-10k



AKR-714108C-C

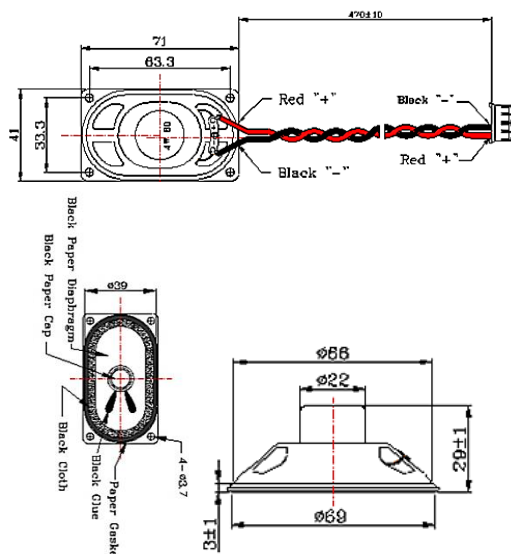

Rated Input Power	(W)	4.0
Max Input Power	(W)	5.0
SPL at 10 cm	(dBA)	100
Impedance	(Ω)	8 \pm 15%
Rated Frequency	(Hz)	450
Frequency Range	(Hz)	450-20k



AKR-878708C-1

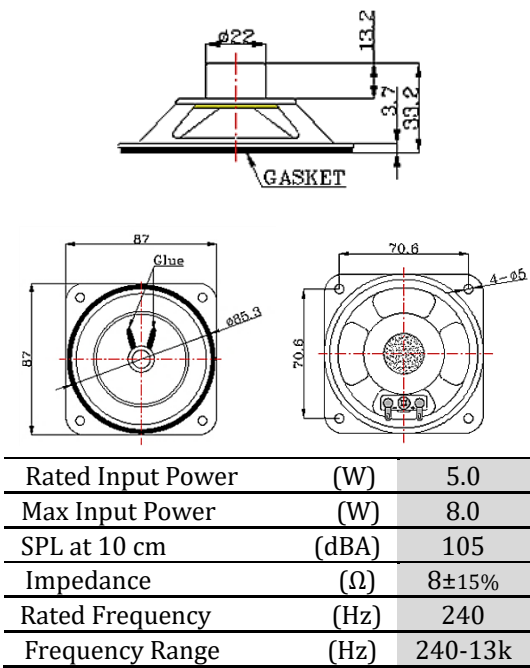

AKR-905008C-1

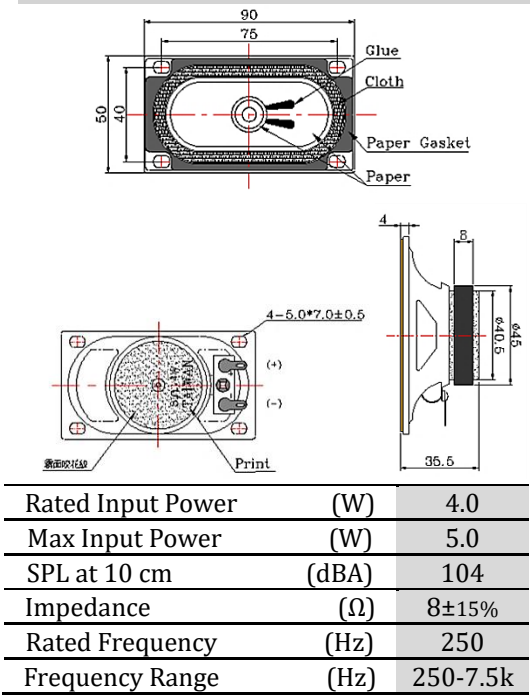

AKR-1021020850-MAP-1

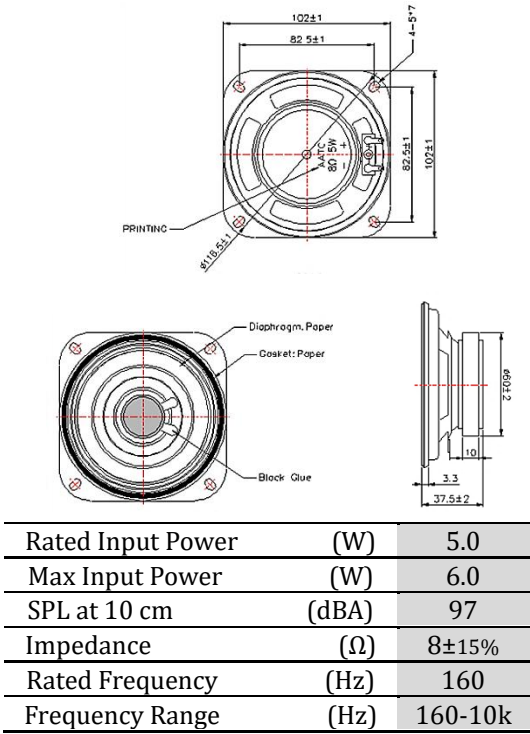

Micro-Speakers (With Box)

AKR-15110801-PP-1C

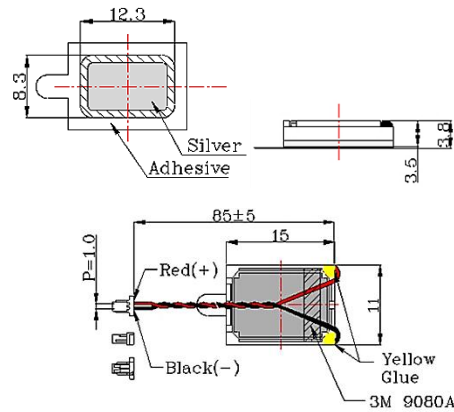

Rated Input Power	(W)	0.1
Max Input Power	(W)	0.15
SPL at 10 cm	(dBA)	80
Impedance	(Ω)	8±15%
Rated Frequency	(Hz)	550
Frequency Range	(Hz)	550-20k



AK-582308CC-1C

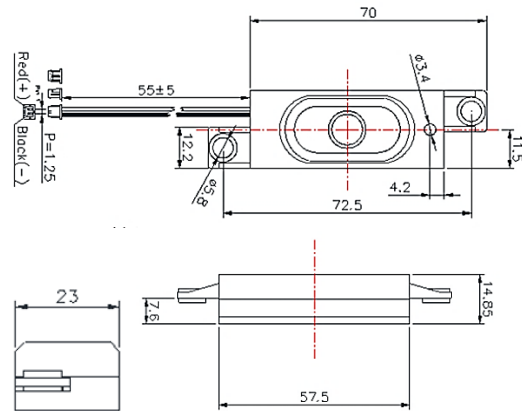

Rated Input Power	(W)	1.0
Max Input Power	(W)	2.0
SPL at 10 cm	(dBA)	93
Impedance	(Ω)	8±15%
Rated Frequency	(Hz)	800
Frequency Range	(Hz)	800-20k



AK-603308BC-8C3

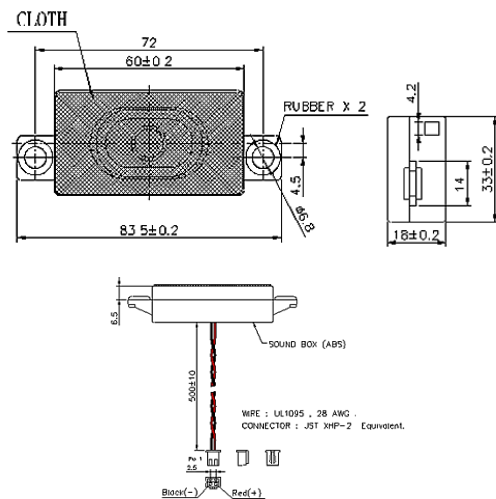

Rated Input Power	(W)	2.0
Max Input Power	(W)	3.0
SPL at 10 cm	(dBA)	95
Impedance	(Ω)	8±15%
Rated Frequency	(Hz)	750
Frequency Range	(Hz)	750-20k



AKB-80310825-PPC-1C

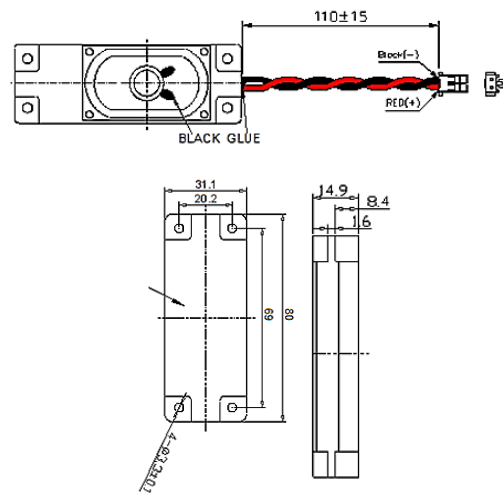

Rated Input Power	(W)	2.5
Max Input Power	(W)	4.0
SPL at 10 cm	(dBA)	101
Impedance	(Ω)	8±15%
Rated Frequency	(Hz)	650
Frequency Range	(Hz)	650-9k



Receivers

AR-1032RA-14C

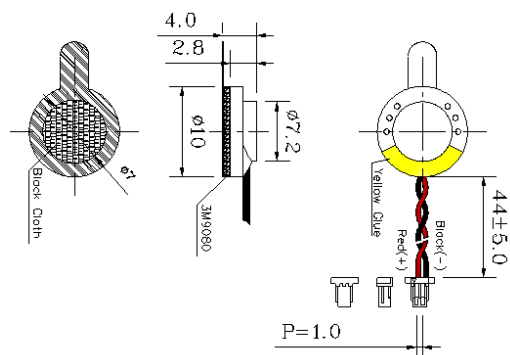

Rated Input Power	(mW)	5
Max Input Power	(mW)	10
SPL	(dBA)	111
Impedance	(Ω)	$32 \pm 15\%$
Frequency Range	(Hz)	550-4k



AR-2732-PM-1

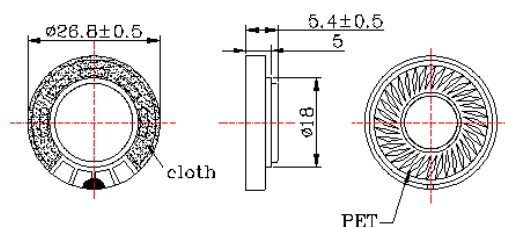

Rated Input Power	(mW)	30
Max Input Power	(mW)	50
SPL	(dBA)	120
Impedance	(Ω)	$32 \pm 15\%$
Frequency Range	(Hz)	300-3.4k



AR-13150DA-9P

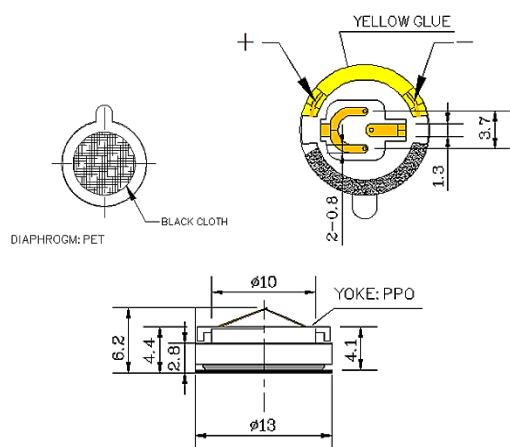

Rated Input Power	(mW)	10
Max Input Power	(mW)	20
SPL	(dBA)	105
Impedance	(Ω)	$150 \pm 15\%$
Frequency Range	(Hz)	100-10k



AR-1532A-3

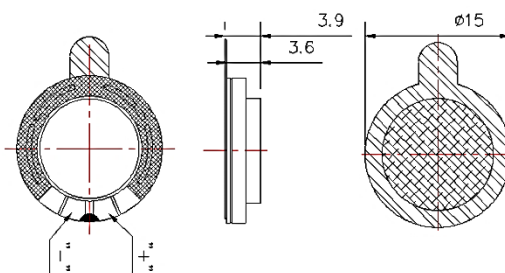

Rated Input Power	(mW)	10
Max Input Power	(mW)	15
SPL	(dBA)	115
Impedance	(Ω)	$32 \pm 15\%$
Frequency Range	(Hz)	300-3.4k

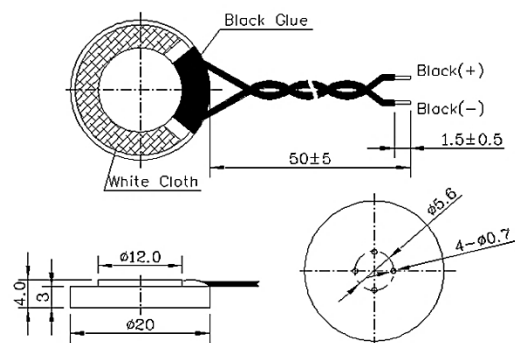

AR-20150AA-2W

Rated Input Power	(mW)	30
Max Input Power	(mW)	50
SPL	(dBA)	92
Impedance	(Ω)	150 \pm 15%
Frequency Range	(Hz)	100-10k

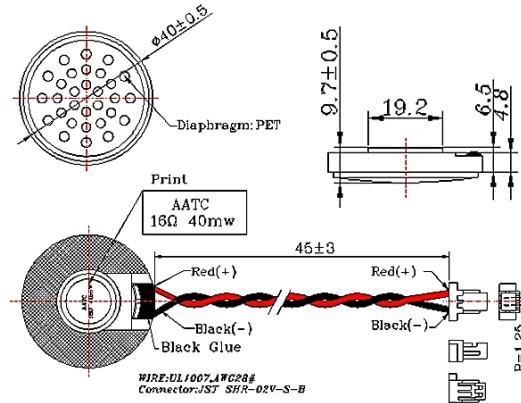
**AR-4016-PP-1C**

Rated Input Power	(mW)	40
Max Input Power	(mW)	60
SPL	(dBA)	120
Impedance	(Ω)	16 \pm 15%
Frequency Range	(Hz)	300-3.4k

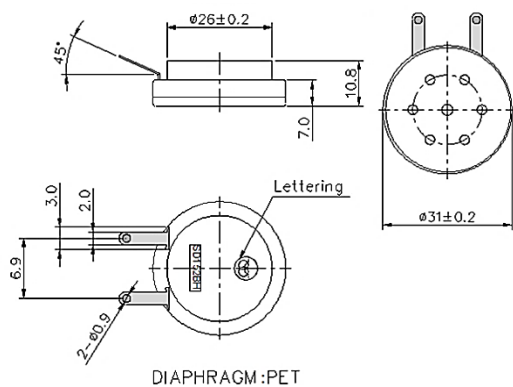
**SD152BH**

Rated Input Power	(mW)	10
Max Input Power	(mW)	20
SPL	(dBA)	93
Impedance	(Ω)	150 \pm 15%
Frequency Range	(Hz)	200-4k

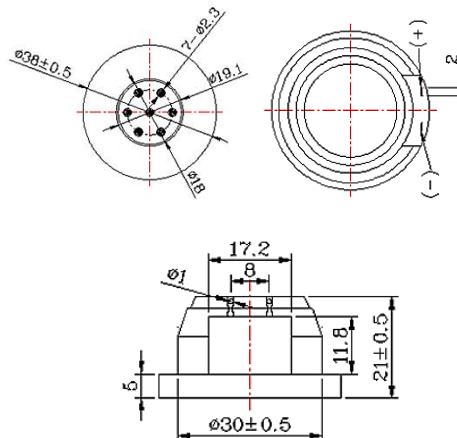
**ART-38150H-PP-1P (SD150)**

Rated Input Power	(mW)	1
Max Input Power	(mW)	10
SPL	(dBA)	94
Impedance	(Ω)	150 \pm 15%
Frequency Range	(Hz)	300-3.4k



Microphones (Omni-Directional; Wire/ Dip)

AMF-O60C42-1CWH

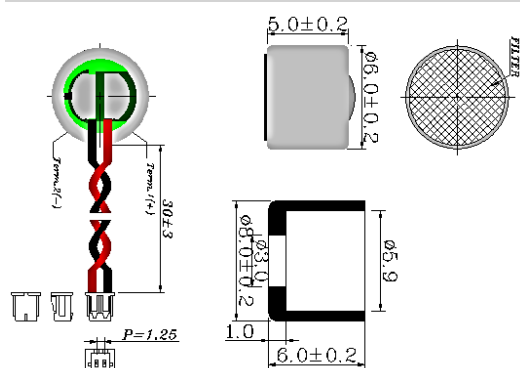

Rated Voltage	(V)	2
Max Voltage	(V)	10
Signal/ Noise Ratio	(min dB)	58
Sensitivity	(dB)	-42
Acoustic Overload Point	(dB)	110
Output Impedance	(Ω)	2.2k



AMF-O97A38-NAH-LF

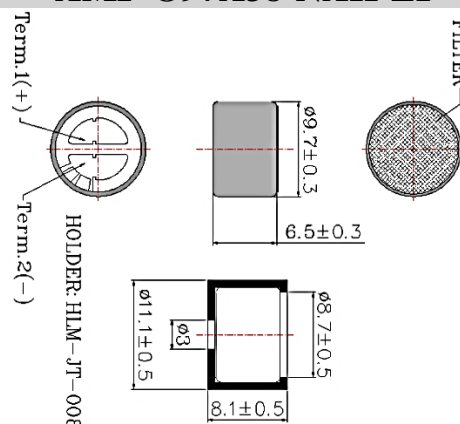

Rated Voltage	(V)	2
Max Voltage	(V)	10
Signal/ Noise Ratio	(min dB)	58
Sensitivity	(dB)	-38
Acoustic Overload Point	(dB)	110
Output Impedance	(Ω)	2.2k



AMF-O97A44-CAH5

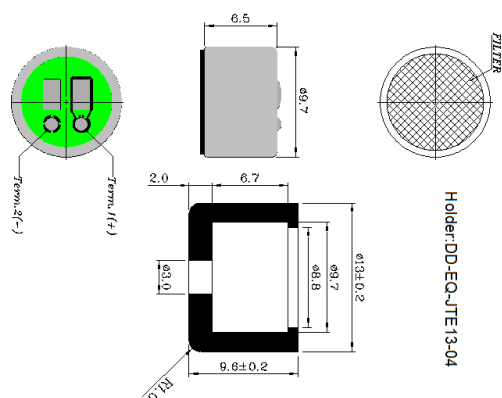

Rated Voltage	(V)	2
Max Voltage	(V)	10
Signal/ Noise Ratio	(min dB)	58
Sensitivity	(dB)	-44
Acoustic Overload Point	(dB)	110
Output Impedance	(Ω)	2.2k



AMF-O97L42-NB1

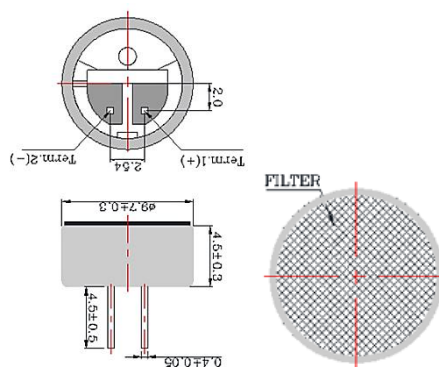

Rated Voltage	(V)	3
Max Voltage	(V)	10
Signal/ Noise Ratio	(min dB)	58
Sensitivity	(dB)	-42
Acoustic Overload Point	(dB)	110
Output Impedance	(Ω)	2.2k



AMB-O40J38-1CWH-IP67

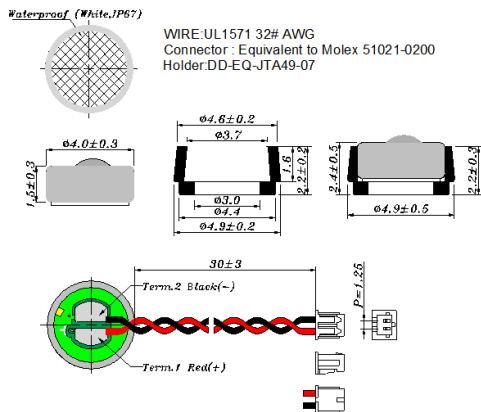

Rated Voltage	(V)	2
Max Voltage	(V)	10
Signal/ Noise Ratio	(min dB)	58
Sensitivity	(dB)	-38
Acoustic Overload Point	(dB)	110
Output Impedance	(Ω)	2.2k



AMB-O40J40-CWH21

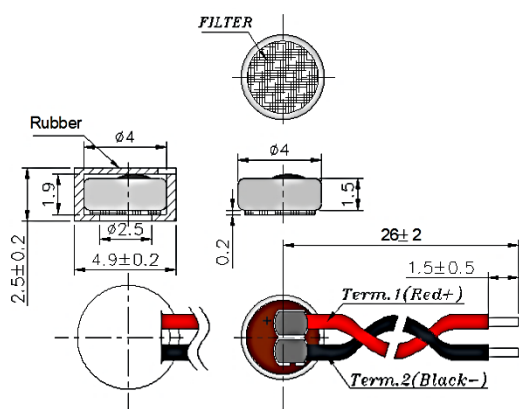

Rated Voltage	(V)	2
Max Voltage	(V)	10
Signal/ Noise Ratio	(min dB)	58
Sensitivity	(dB)	-40
Acoustic Overload Point	(dB)	110
Output Impedance	(Ω)	2.2k



AMB-O40J42-1FB

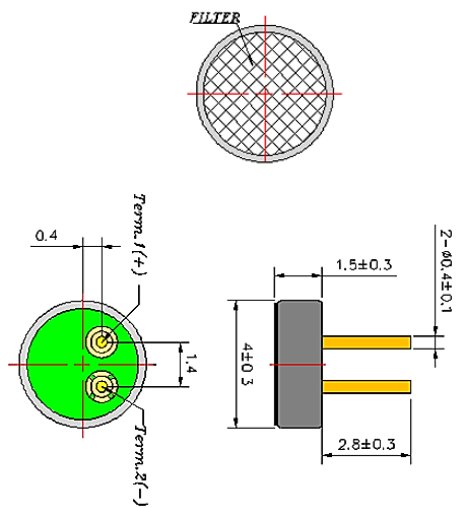

Rated Voltage	(V)	2
Max Voltage	(V)	10
Signal/ Noise Ratio	(min dB)	58
Sensitivity	(dB)	-42
Acoustic Overload Point	(dB)	110
Output Impedance	(Ω)	2.2k



AMB-O40J44-CCH-IP67

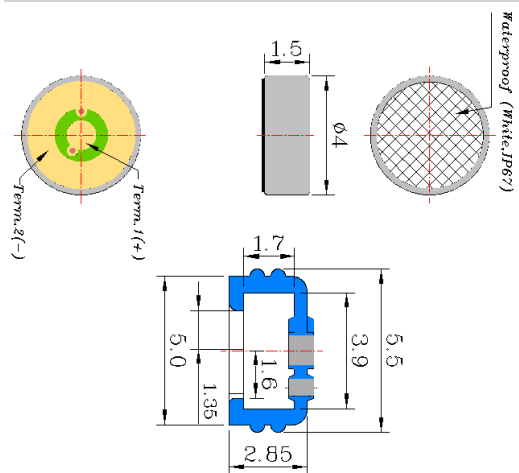

Rated Voltage	(V)	2
Max Voltage	(V)	10
Signal/ Noise Ratio	(min dB)	58
Sensitivity	(dB)	-44
Acoustic Overload Point	(dB)	110
Output Impedance	(Ω)	2.2k



AMB-O60F42-5RWH

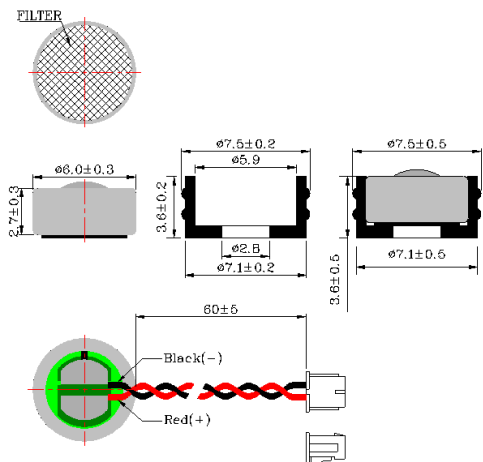

Rated Voltage	(V)	2
Max Voltage	(V)	10
Signal/ Noise Ratio	(min dB)	58
Sensitivity	(dB)	-42
Acoustic Overload Point	(dB)	110
Output Impedance	(Ω)	2.2k



AMB-O60G42-2CWH

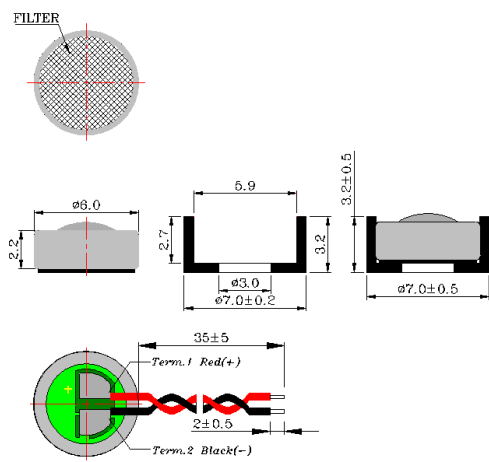

Rated Voltage	(V)	2
Max Voltage	(V)	10
Signal/ Noise Ratio	(min dB)	58
Sensitivity	(dB)	-42
Acoustic Overload Point	(dB)	110
Output Impedance	(Ω)	2.2k



AMB-O60G44-CB1-LF

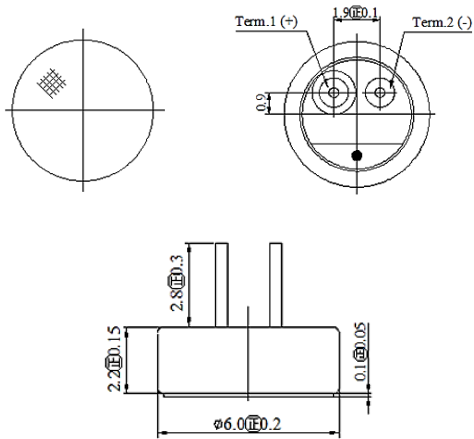

Rated Voltage	(V)	2
Max Voltage	(V)	10
Signal/ Noise Ratio	(min dB)	58
Sensitivity	(dB)	-44
Acoustic Overload Point	(dB)	110
Output Impedance	(Ω)	2.2k

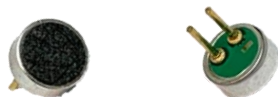

AMB-O60J44-CCH4

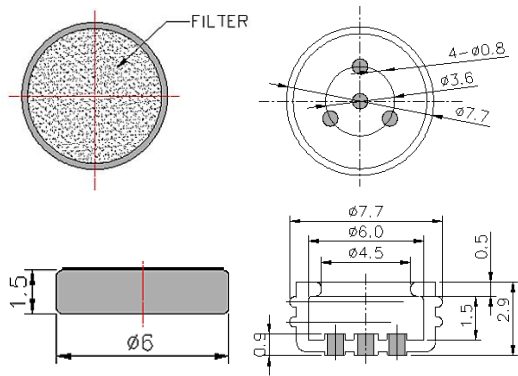

Rated Voltage	(V)	2
Max Voltage	(V)	10
Signal/ Noise Ratio	(min dB)	58
Sensitivity	(dB)	-44
Acoustic Overload Point	(dB)	110
Output Impedance	(Ω)	2.2k



Microphones (Omni-Directional; SMD)

AMS-O40J44-1CC

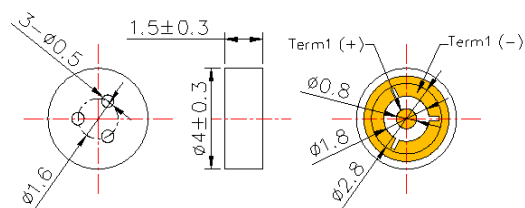

Rated Voltage	(V)	2
Max Voltage	(V)	10
Signal/ Noise Ratio	(min dB)	55
Sensitivity	(dB)	-44
Acoustic Overload Point	(dB)	110
Output Impedance	(Ω)	2.2k



AMS-O40S42-EC1

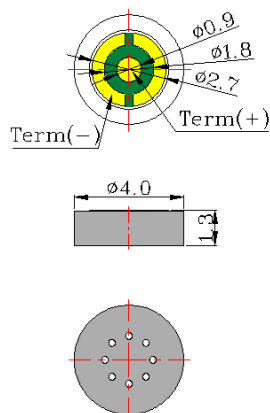

Rated Voltage	(V)	2
Max Voltage	(V)	10
Signal/ Noise Ratio	(min dB)	55
Sensitivity	(dB)	-42
Acoustic Overload Point	(dB)	110
Output Impedance	(Ω)	2.2k



AMS-O40S47-E1

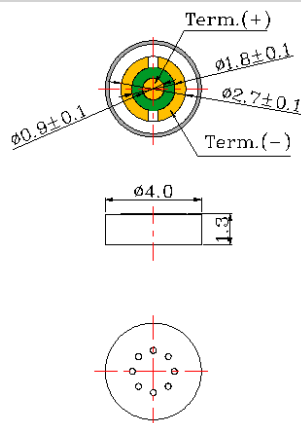

Rated Voltage	(V)	2
Max Voltage	(V)	10
Signal/ Noise Ratio	(min dB)	58
Sensitivity	(dB)	-47
Acoustic Overload Point	(dB)	110
Output Impedance	(Ω)	2.2k



Microphones (Uni-Directional; Wire/ Dip)

AMB-U40J51-1CW

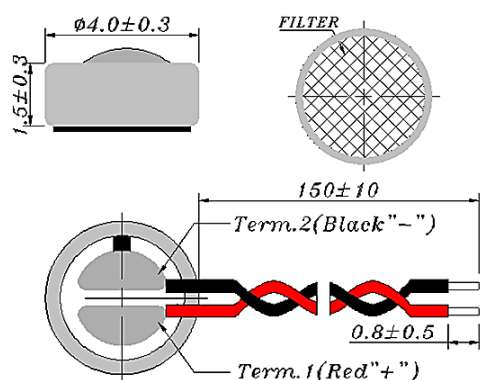

Rated Voltage	(V)	2
Max Voltage	(V)	10
Signal/ Noise Ratio	(min dB)	55
Sensitivity	(dB)	-51
Acoustic Overload Point	(dB)	110
Output Impedance	(Ω)	2.2k



AMB-U60F40-CA-LF

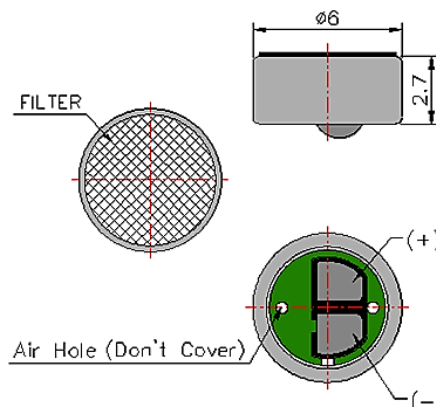

Rated Voltage	(V)	2
Max Voltage	(V)	10
Signal/ Noise Ratio	(min dB)	55
Sensitivity	(dB)	-40
Acoustic Overload Point	(dB)	110
Output Impedance	(Ω)	2.2k



AMB-U60F42-CA

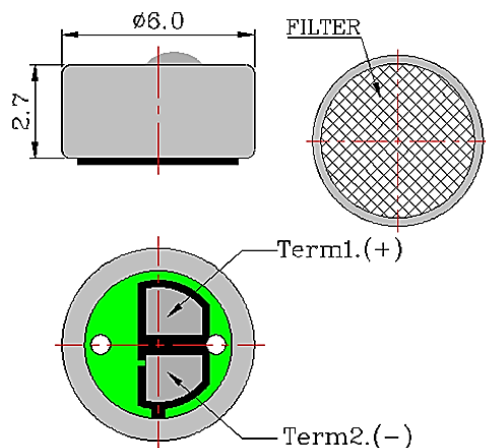

Rated Voltage	(V)	2
Max Voltage	(V)	10
Signal/ Noise Ratio	(min dB)	55
Sensitivity	(dB)	-42
Acoustic Overload Point	(dB)	110
Output Impedance	(Ω)	2.2k



AMB-U60F47-1FAH1

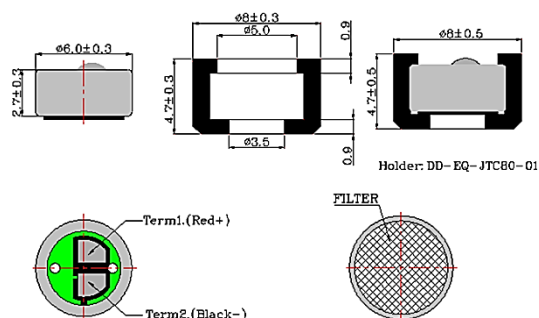

Rated Voltage	(V)	2
Max Voltage	(V)	10
Signal/ Noise Ratio	(min dB)	55
Sensitivity	(dB)	-47
Acoustic Overload Point	(dB)	110
Output Impedance	(Ω)	2.2k



Contact Us

Advanced Acoustic Technology Corporation (AATC) is headquartered in Taipei, Taiwan: No. 2, No. 207, Zhongshan North Road, Shihlin District, Taipei City, 111, Taiwan (R.O.C.)

Tel: +886-02-8866-5255

Fax: +886-02-8866-5250

Email: sales-tp@aatc.tw

Website: www.aatc.tw

OR

Email: sales@aatc.com.tw

Website: www.aatc.com.tw

