

5	6	7	8
REV	DATE	ECN NO.	MODIFICATION
A	2016/10/14		NEW
A1	2017/05/15	RD00317051501	SIZE CHANGE
			APPROVER
			Jason_Lee
			Jason_Lee

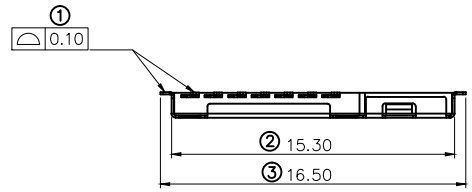

NOTES:
MATERIAL:
Housing: High Temperature thermoplastic,UL94V-0
Terminal: Copper Alloy
Shell: Stainless
SPECIALITY:
Rated Current:0.5A MAX
Rated Voltage:50V
Ambient Temperature Range: -40°C~+85°C
storage Temperature Range: -40°C~+85°C
Ambient Humidity Range :95% R.H. Max.
Contact Resistance:100mΩ Max
Insulation Resistance:1000MΩ/250V DC
Dielectric Withstanding Voltage:500V AC
Durability:5000 cycles
Temperature 260±5°C,

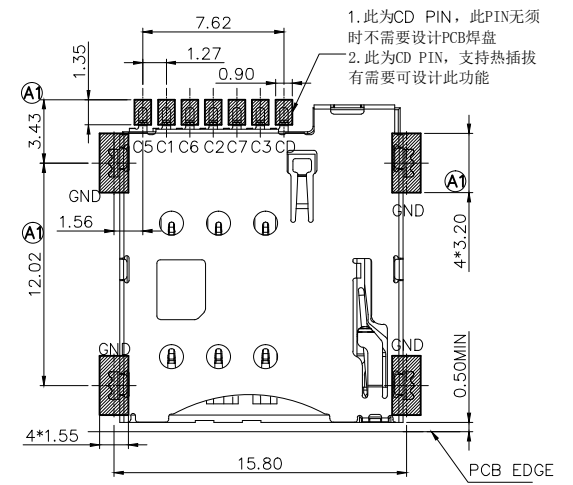
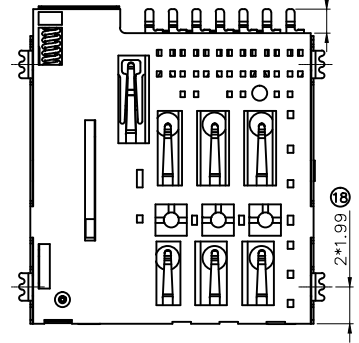
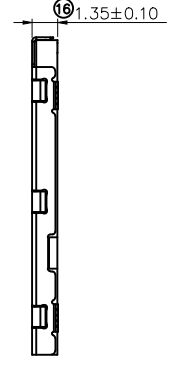
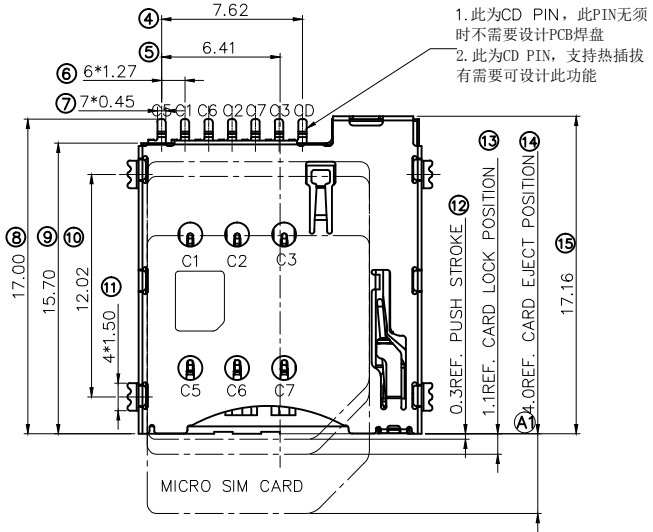

IM pin Assignment	
IN#	Name
C1	VCC
C2	RST
C3	CLK
C5	GND
C6	VPP
C7	I/O

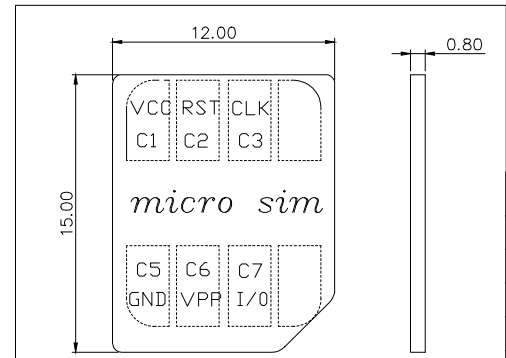
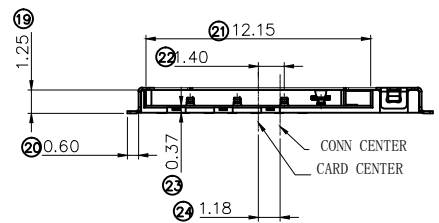

RECOMMENDED PCB LAYOUT
GENERAL TOLERANCE±0.05

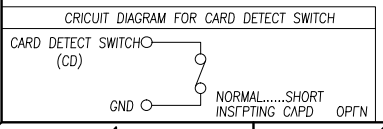

GENERAL TOLERANCE		UNITS	NAME: MICRO SIM CARD 6P PUSH PUSH		深圳市爱特姆科技有限公司 SHENZHEN ATOM TECHNOLOGY CO., LTD.
SELECT	TOL.	mm	PART NO: S162C-01200		
ON.	1 2 3	MAT'L	APPD:		TITLE: CUSTOMER DRAWING FOR MICRO SIM CARD 6P P-P H=1.35mm带检测脚 无柱
X.XXX	±0.10±0.05±0.15	FINISH	CHKD:		DWG NO. ATOM-A03337
X.XX	±0.15±0.13±0.25		DR: JACK		SCALE 1:1
X.X	±0.20±0.25±0.5	Q'TY	DR: JACK		SHEET 1/1
X.	±0.30±0.35±1.00		DR: JACK		REV A1
ANGLE	±2'				